



English

LG-E510 User Guide

This guide helps you get started using your phone.

If you need more information, please visit www.lg.com.

- Some of the contents of this manual may not apply to your phone. This depends on your phone's software and your service provider.
- This handset is not recommended for the visually impaired because of its touch screen keyboard.
- Copyright ©2011 LG Electronics, Inc. All rights reserved. LG and the LG logo are registered trademarks of LG Group and its related entities. All other trademarks are the property of their respective owners.
- Google™, Google Maps™, Google mail™, YouTube™, Google Talk™ and Android Market™ are trademarks of Google, Inc.



Contents

Guidelines for safe and efficient use	7	Your Home screen	41	Entering accented letters	52
Important notice	18	Touch screen tips.....	41	Google account setup ...	53
Getting to know your phone	33	Lock your phone	42	Wi-Fi	55
Installing the SIM card and battery	36	Unlock screen.....	43	Turning on Wi-Fi.....	55
Charging your phone	37	Silent mode	43	Connecting to Wi-Fi.....	55
Installing the memory card	38	Home	43	Sharing your phone's data connection.....	56
Formatting the memory card	40	Adding widgets to your Home screen	44	USB tethering & portable Wi-Fi hotspot settings...57	
		Returning to recently-used applications	46	To share your phone's data connection via USB	58
		Notification drawer	46		
		Viewing the status bar ..	47		
		Onscreen keyboard	51		

USB tethering and data sharing.....	59
To share your phone's data connection as a portable Wi-Fi hotspot ..	60
To rename or secure your portable hotspot.....	60
Enabling Wi-Fi Direct to share through SmartShare	62
Using the Wi-Fi Cast.....	63

On-Screen Phone.....	65
How to use On-Screen Phone	65
On-Screen Phone icons	65
On-Screen Phone features.....	65
How to install On-Screen Phone on your PC	66
How to connect your mobile phone to your PC	67
To check the phone to PC connection.....	68

To disconnect your phone from your PC	69
Calls.....	70
Making a call	70
Calling your contacts	70
Answering and rejecting a call.....	70
Adjusting call volume ...	71
Making a second call ...	71
Viewing your call logs...	72
Call settings.....	72
Contacts.....	73
Searching for a contact	73

Contents

Adding a new contact...73	Composing and Sending	Camera87
Favorite contacts.....74	Email.....80	Getting to know the
Moving contacts from your	Working with Account	viewfinder.....87
old phone to your new	Folders.....82	Taking a quick photo ...88
phone75	Adding and Editing email	Once you've taken the
Messaging/E-mail.....76	Accounts.....82	photo88
Messaging.....76	Social Networking84	Using the advanced
Sending a message.....76	Social Networking84	settings89
Threaded box77	Adding your account to	Viewing your saved
Using Smilies.....77	your phone84	photos.....92
Changing your message	Viewing and updating your	Video camera.....93
settings78	status85	Getting to know the
Opening Email and the	Removing accounts from	viewfinder.....93
Accounts Screen.....78	your phone86	

Shooting a quick video .94	Playing a song99	Utilities.....107
After shooting a video...94	Transferring files using	Setting your alarm.....107
Using the advanced	USB mass storage	Using your calculator..107
settings95	devices.....101	Adding an event to your
Watching your saved	How to Transfer music/	calendar108
videos96	video files to your	Changing your calendar
Adjusting the volume	phone101	view109
when viewing a video ...96	Sending data from your	Polaris Viewer109
Multimedia.....97	phone using Bluetooth102	Voice recorder110
View mode97	FM Radio.....104	Recording a sound or
Timeline view.....97	Searching for stations 104	voice110
Using SmartShare98	Resetting channels.....105	Sending the voice
Music.....99	Listening to the radio..106	recording.....110

Contents

The Web	111	Privacy	122	Accessories	132
Browser.....	111	SD card & phone		Technical data	133
Using the web toolbar.	111	storage.....	123	Troubleshooting	134
Using options.....	112	Language & keyboard	124		
Settings	114	Voice input & output...	124		
Wireless & networks...	114	Accessibility.....	126		
Call settings.....	116	Date & time	126		
Sound	118	About phone.....	127		
Display	119	Software update	128		
Location & security	120	Phone software			
Applications.....	121	update	128		
Accounts & sync	122	DivX Mobile	130		

Guidelines for safe and efficient use

Please read these simple guidelines. Not following these guidelines may be dangerous or illegal.

Exposure to radio frequency energy

Radio wave exposure and Specific Absorption Rate (SAR) information. This mobile phone model LG-E510 has been designed to comply with applicable safety requirements for exposure to radio waves. These requirements are based on scientific guidelines that include safety margins designed to assure the safety of all persons,

regardless of age and health.

- The radio wave exposure guidelines employ a unit of measurement known as the Specific Absorption Rate, or SAR. Tests for SAR are conducted using standardised methods with the phone transmitting at its highest certified power level in all used frequency bands.
- While there may be differences between the SAR levels of various LG phone models, they are all designed to meet the relevant guidelines for exposure to radio waves.

Guidelines for safe and efficient use

- The SAR limit recommended by the International Commission on Non-Ionizing Radiation Protection (ICNIRP) is 2 W/kg averaged over 10 g of tissue.
- The highest SAR value for this model phone tested by DASY4 for use at the ear is 0.713 W/kg (10 g) and when worn on the body is 1.12 W/kg (10 g).
- SAR data information for residents in countries/regions that have adopted the SAR limit recommended by the Institute of Electrical and Electronics Engineers (IEEE), which is 1.6 W/kg averaged over 1g of tissue.

Product care and maintenance

WARNING

Only use batteries, chargers and accessories approved for use with this particular phone model. The use of any other types may invalidate any approval or warranty applying to the phone, and may be dangerous.

- Do not disassemble this unit. Take it to a qualified service technician when repair work is required.

- Repairs under warranty, at LG's option, may include replacement parts or boards that are either new or reconditioned, provided that they have functionality equal to that of the parts being replaced.
- Keep away from electrical appliances such as TVs, radios, and personal computers.
- The unit should be kept away from heat sources such as radiators or cookers.
- Do not drop.
- Do not subject this unit to mechanical vibration or shock.
- Switch off the phone in any area where you are required by special regulations. For example, do not use your phone in hospitals as it may affect sensitive medical equipment.
- Do not handle the phone with wet hands while it is being charged. It may cause an electric shock and can seriously damage your phone.
- Do not charge a handset near flammable material as the handset can become hot and create a fire hazard.

Guidelines for safe and efficient use

- Use a dry cloth to clean the exterior of the unit (do not use solvents such as benzene, thinner or alcohol).
- Do not charge the phone when it is on soft furnishings.
- The phone should be charged in a well ventilated area.
- Do not subject this unit to excessive smoke or dust.
- Do not keep the phone next to credit cards or transport tickets; it can affect the information on the magnetic strips.
- Do not tap the screen with a sharp object as it may damage the phone.
- Do not expose the phone to liquid or moisture.
- Use the accessories like earphones cautiously. Do not touch the antenna unnecessarily.
- Do not use, touch or attempt to remove or fix broken, chipped or cracked glass. Damage to the glass display due to abuse or misuse is not covered under the warranty.

- Your phone is an electronic device that generates heat during normal operation. Extremely prolonged, direct skin contact in the absence of adequate ventilation may result in discomfort or minor burns. Therefore, use care when handling your phone during or immediately after operation.

Efficient phone operation

Electronics devices

All mobile phones may get interference, which could affect performance.

- Do not use your mobile phone near medical equipment without requesting permission. Avoid placing the phone over pacemakers, for example, in your breast pocket.
- Some hearing aids might be disturbed by mobile phones.
- Minor interference may affect TVs, radios, PCs, etc.

Road safety

Check the laws and regulations on the use of mobile phones in the area when you drive.

Guidelines for safe and efficient use

- Do not use a hand-held phone while driving.
- Give full attention to driving.
- Pull off the road and park before making or answering a call if driving conditions so require.
- RF energy may affect some electronic systems in your vehicle such as car stereos and safety equipment.
- When your vehicle is equipped with an air bag, do not obstruct with installed or portable wireless equipment. It can cause the air bag to fail or cause serious injury due to improper performance.
- If you are listening to music whilst out and about, please ensure that the volume is at a reasonable level so that you are aware of your surroundings. This is particularly imperative when near roads.

Avoid damage to your hearing

Damage to your hearing can occur if you are exposed to loud sound for long periods of time. We therefore recommend that you do not turn on or off the handset close to your ear. We also recommend that music and call volumes are set to a reasonable level.

- When using headphones, turn the volume down if you cannot hear the people speaking near you, or if the person sitting next to you can hear what you are listening to.

NOTE: Excessive sound pressure from earphones can cause hearing loss.

Glass Parts

Some parts of your mobile device are made of glass. This glass could break if your mobile device is dropped on a hard surface or receives a substantial impact. If the glass

breaks, do not touch or attempt to remove. Stop using your mobile device until the glass is replaced by an authorised service provider.

Blasting area

Do not use the phone where blasting is in progress. Observe restrictions, and follow any regulations or rules.

Potentially explosive atmospheres

- Do not use the phone at a refueling point.
- Do not use near fuel or chemicals.

Guidelines for safe and efficient use

- Do not transport or store flammable gas, liquid, or explosives in the same compartment of your vehicle as your mobile phone and accessories.

In aircraft

Wireless devices can cause interference in aircraft.

- Turn your mobile phone off before boarding any aircraft.
- Do not use it on the ground without permission from the crew.

Children

Keep the phone in a safe place out of the reach of small children. It includes small parts which may cause a choking hazard if detached.

Emergency calls

Emergency calls may not be available under all mobile networks. Therefore, you should never depend solely on the phone for emergency calls. Check with your local service provider.

Battery information and care

- You do not need to completely discharge the battery before recharging. Unlike other battery systems, there is no memory effect that could compromise the battery's performance.
- Use only LG batteries and chargers. LG chargers are designed to maximise the battery life.
- Do not disassemble or short-circuit the battery pack.
- Keep the metal contacts of the battery pack clean.
- Replace the battery when it no longer provides acceptable performance. The battery pack may be recharged hundreds of times until it needs replacing.
- Recharge the battery if it has not been used for a long time to maximise usability.
- Do not expose the battery charger to direct sunlight or use it in high humidity, such as in the bathroom.
- Do not leave the battery in hot or cold places, this may deteriorate the battery performance.

Guidelines for safe and efficient use

- There is risk of explosion if the battery is replaced by an incorrect type.
- Dispose of used batteries according to the manufacturer's instructions. Please recycle when possible. Do not dispose as household waste.
- If you need to replace the battery, take it to the nearest authorised LG Electronics service point or dealer for assistance.
- Always unplug the charger from the wall socket after the phone is fully charged to save unnecessary power consumption of the charger.
- Actual battery life will depend on network configuration, product settings, usage patterns, battery and environmental conditions.



Disposal of your old appliance

- 1 When this crossed-out wheeled bin symbol is attached to a product it means the product is covered by the European Directive 2002/96/EC.
- 2 All electrical and electronic products should be disposed of separately from the municipal waste stream via designated collection facilities appointed by the government or the local authorities.
- 3 The correct disposal of your old appliance will help prevent potential negative consequences for the environment and human health.
- 4 For more detailed information about disposal of your old appliance, please contact your city office, waste disposal service or the shop where you purchased the product.



Disposal of waste batteries/accumulators

- 1 When this crossed-out wheeled bin symbol is attached to batteries/ accumulators of your product it means they are covered by the European Directive 2006/66/EC.
- 2 This symbol may be combined with chemical symbols for mercury (Hg), cadmium (Cd) or lead (Pb) if the battery Contains more than 0.0005% of mercury, 0.002% of cadmium or 0.004% of lead.
- 3 All batteries/accumulators should be disposed separately from the municipal waste stream via designated collection facilities appointed by the government or the local authorities.
- 4 The correct disposal of your old batteries/accumulators will help to prevent potential negative consequences for the environment, animal and human health.
- 5 For more detailed information about disposal of your old batteries/ accumulators, please contact your city office, waste disposal service or the shop where you purchased the product.

Important notice

Please check to see whether any problems you encountered with your phone are described in this section before taking the phone in for service or calling a service representative.

1. Phone memory

When available space in your phone memory is less than 10%, your phone cannot receive new messages. You need to check your phone memory and delete some data, such as applications or messages, to make more memory available.

Managing applications

- 1 In the Home screen, touch the **Applications** tab, then select **Settings > Applications > Manage applications**.
- 2 Once all applications appear, scroll to and select the application you want to uninstall.
- 3 Tap **Uninstall**, then touch **OK** to uninstall the application you selected.

2. Optimising battery life

Extend your battery's life between charges by turning off features you don't need to run constantly in the background. You can monitor how applications and system resources consume battery power.

Extending your battery's life

- Turn off radio communications you are not using. If you are not using Wi-Fi, Bluetooth or GPS, turn them off.
- Reduce screen brightness and set a shorter screen timeout.

- Turn off automatic syncing for Google Mail™, Calendar, Contacts and other applications.
- Some applications you have downloaded may cause your battery life to be reduced.

Checking the battery charge level

- 1 In the Home screen, touch the **Applications** tab, then select **Settings** > **About phone** > **Status**.
- 2 The battery status (Charging, Not charging) and level (percentage charged) is displayed at the top of the screen.

Important notice

Monitoring and controlling what uses the battery

- 1 In the Home screen, touch the **Applications** tab, then select **Settings > About phone > Battery use**.
- 2 Battery usage time is displayed at the top of the screen. It tells you how long it has been since you last connected to a power source or, if connected to a power source, how long you were last running on battery power. The body of the screen lists applications or services using battery power, from greatest amount to least.

3. Installing an open source operating system

If you install and use an open source operating system (OS) on your phone rather than using the OS provided by the manufacturer, your phone may malfunction.

WARNING

If you install and use an OS other than the one provided by the manufacturer, your phone is no longer covered by the warranty.

 **WARNING**

To protect your phone and personal data, only download applications from trusted sources, such as Android Market™. If there are improperly installed applications on your phone, your phone may not work normally or a serious error may occur. You must uninstall those applications and all their data and settings from the phone.

4. Using unlock pattern

Set unlock pattern to secure your phone. This opens a set of screens that guide you through how to draw a screen unlock pattern.

Caution: Create a Google mail account before setting an unlock pattern.

Important notice



Precautions to take when using pattern lock.

It is very important to remember the unlock pattern you set. You will not be able to access your phone if you use an incorrect pattern 5 times. You have 5 opportunities to enter your unlock pattern, PIN or password. If you have used all 5 opportunities, you can try again after 30 seconds.

When you cannot recall your unlock pattern:

If you logged in to your Google account on the phone but failed to enter the correct pattern 5 times, tap on the Forgotten pattern button. You are then required to log in with your Google account to unlock your phone.

If you have not created a Google account on the phone or you forgot it, you have to perform a hard reset.

Caution: If you perform a hard reset, all user applications and user data are deleted.

5. Using the hard reset

If it does not restore to the original condition, use hard reset to initialise your phone.

When the phone is turned off, press and hold the **Volume down key + Power key** for over ten seconds. When the screen shows the LG logo, release the **Power** key.

After the screen shows the hard reset screen, release the other keys.

Leave your phone for at least a minute while it performs the hard reset, then your phone will be turned on.

Caution: If you perform a hard reset, all user applications and user data are deleted. This cannot be reversed. Remember to back up any important data before performing a hard reset.

6. Connecting to Wi-Fi networks

To use Wi-Fi on your phone, you need to access a wireless access point or “hotspot.” Some access points are open and you can simply connect to them. Others are hidden or use security features; you must configure your phone to be able to connect to them.

Important notice

Turn off Wi-Fi when you're not using it to extend the life of your battery.

Turning Wi-Fi on and connecting to a Wi-Fi network

- 1 In the Home screen, touch the **Applications** tab, then select **Settings > Wireless & networks > Wi-Fi settings**.
- 2 Touch **Wi-Fi** to turn it on and begin scanning for available Wi-Fi networks.
 - A list of available Wi-Fi networks is displayed. Secured networks are indicated by a lock icon.
- 3 Touch a network to connect to it.
 - If the network is open, you are asked to confirm that you want to connect to that network by touching **Connect**.
 - If the network is secure, you're asked to enter a password or other credentials. (Ask your network administrator for details)
- 4 The status bar displays icons that indicate Wi-Fi status.

7. Using a microSD card

Pictures, along with music and video files, can only be saved to external memory.

Before using the built-in camera, you first need to insert a microSD memory card into your phone.

If you don't insert a memory card, you cannot save the pictures and video you take with the camera.

WARNING

Do not insert or remove the memory card when the phone is on. Doing so may damage the memory card as well as your phone, and the data stored on the memory card may be corrupted. To remove the memory card safely, in the Home screen, touch the **Applications** tab, then select **Settings > SD card & phone storage > Unmount SD card.**

Important notice

8. Opening and switching applications

Multitasking is easy with Android because you can keep more than one application running at the same time. There's no need to quit an application before opening another. Use and switch between several open applications. Android manages each application, stopping and starting them as needed to ensure that idle applications don't consume resources unnecessarily.

Stopping applications

- 1 In the Home screen, touch the **Applications** tab, then select **Settings > Applications > Manage applications**.
- 2 Scroll to the desired application and touch **Force stop** to stop it.

TIP! Returning to recent apps Press and hold the Home key. A screen then displays a list of the applications you used recently.

9. Copying LG PC Suite from an SD card

LG PC Suite IV is a program that helps you connect your mobile phone to a PC using a USB data communication cable. Once connected, you can use the functions of the mobile phone on your PC.

Major functions of LG PC Suite IV

- Create, edit and delete phone data with ease
- Synchronise mobile phone data with PC data (contacts, calendar, SMS messages, bookmarks and call log)
- Easily transfer multimedia files (photos, videos, music) by simply dragging and dropping between a PC and your phone
- Transfer SMS messages from your phone to a PC
- Software update without losing your data

Installing LG PC Suite from your microSD memory card

- 1 Insert your microSD memory card into your phone. (It may already be inserted)
- 2 Before connecting the USB data cable, make sure that Mass storage only mode is enabled on your phone. (In the

Important notice

applications menu, choose Settings > Storage > Mass storage only check box.)

- 3 Use the USB data cable to connect your phone to the PC.
- 4
 - In the status bar, drag the USB icon.
 - Choose **USB connected** and **Turn on USB storage**. Then touch OK to confirm
 - You can view the mass storage content on your PC and transfer files.
- 5
 - Copy the LGPCSuiteIV folder in mass storage to your PC.

- Run the LGInstaller.exe file on your PC and follow the instructions.

* When LG PC Suite IV installation is complete, disable **Mass storage only** mode to run LG PC Suite IV.

NOTE: Do not remove or delete other program files installed on your memory card. This may damage your preinstalled applications.

10. Connecting your phone to a computer using USB

NOTE: To synchronise your phone with your PC using the USB cable, you need to install

LG PC Suite onto your PC. Download the program from the LG website (www.lg.com). Go to www.lg.com and select your region, country and language. For more information, visit the various pages of the site. Since PC Suite is on the microSD card, you can simply copy it to your PC.

LG-E510 does not support:

- LG Air Sync (Web Sync, R-Click)
- To-do in Calendar
- Memo
- Java application

After installing PC Suite IV, you can find the User Guide in the Help menu.

- 1** Use the USB cable to connect your phone to a USB port on your computer. Once connected, you will receive a notification that a USB connection has been made.
- 2** Open the notification drawer and touch **USB connected**.
- 3** Touch **Turn on USB storage** then touch OK to confirm that you want to transfer files between your phone's microSD card and the computer.

You will receive a notification when the phone connects as USB storage. Your

Important notice

phone's microSD card is mounted as a drive on your computer. You can now copy files to and from the microSD card.

NOTE: When uninstalling PC Suite IV, USB and Bluetooth, drivers are not automatically removed. You must uninstall them manually.

TIP! To use the microSD card on your phone again, you need to open the notification drawer and touch **Turn off USB storage**.

During this time, you can't access the microSD card from your phone, so you can't

use applications that rely on the microSD card, such as Camera, Gallery and Music.

To disconnect your phone from the computer, carefully follow your computer's instructions for properly disconnecting USB devices to avoid losing information on the card.

- 1 Open the notification drawer and touch **Turn off USB storage**.
- 2 Safely disconnect the USB device from your computer.

11. Unlocking the screen when using a data connection

Your display goes dark if untouched for a period of time when using a data connection. To turn on your LCD screen, Press lock key.

12. Hold your phone straight up

Hold your mobile phone straight up, as you would a regular phone. The LG-E510 has an internal antenna. Be careful not to scratch or damage the back of the phone, as that causes loss of performance.

While making/receiving calls or sending/receiving data, avoid holding the lower part of the phone where the antenna is located. Doing so may affect call quality.

13. When the screen freezes

If the screen freezes or the phone does not respond when you try to operate it:

Remove the battery, reinsert it, then turn the phone on. If it still does not work, please contact the service centre.

Important notice

14. Do not connect your phone when you turn on/off your PC.

Make sure you disconnect the data cable between your phone and PC; leaving it connected might cause errors on your PC.

Getting to know your phone

To turn on your phone, press and hold the Power key for 3 seconds.

To turn off the phone, press and hold the Power key for 3 seconds, then touch **Power off** and **OK**.

Speaker/Receiver

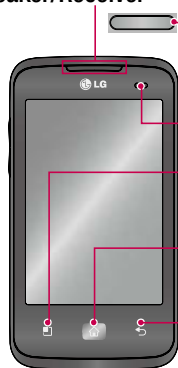

Power/Lock key

Switch your phone on/off by pressing and holding this key.
Turn off and lock the screen.

Proximity sensor

Menu key

Check what options are available.

Home key

Return to home from any screen.

Back key

Return to the previous screen.

Stereo earphone connector



Power/Lock key

Getting to know your phone

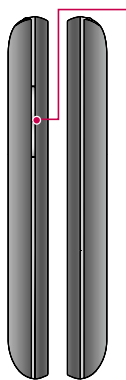

Volume keys

On the home screen: control ringer volume.

- During a call: control your In-Call volume.
- When playing a track: control volume continuously.

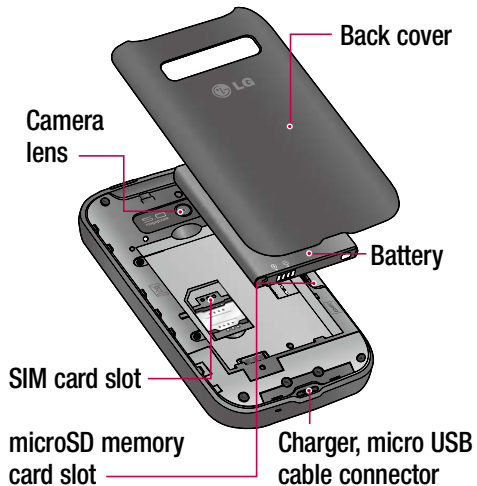

NOTE: Proximity sensor

When receiving and making calls, the proximity sensor automatically turns the backlight off and locks the touch keypad by sensing when the phone is near your ear. This extends battery life and prevents the touch keypad from activating unintentionally during calls.

 **WARNING**

Placing a heavy object on the phone or sitting on it can damage its LCD and touch screen functions. Do not cover the protective film on the LCD's proximity sensor. This may cause the sensor to malfunction.

Getting to know your phone

Installing the SIM card and battery

- 1 To remove the back cover, hold the phone in your hand firmly. With the other hand, firmly press your thumb on the back cover. Now lift off the battery cover.

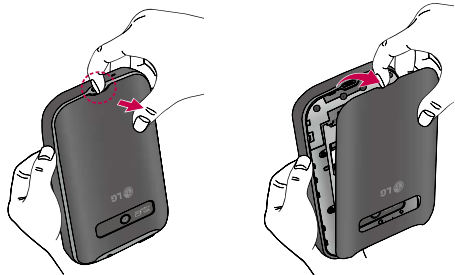

- 2 Slide the SIM card into the SIM card slot. Make sure the gold contact area on the card is facing downwards.

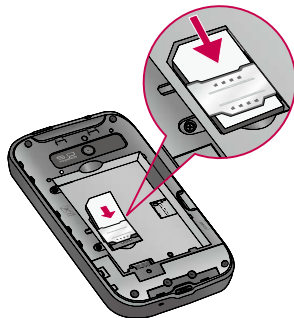

- 3 Insert the battery by aligning the gold contacts on the phone and the battery.

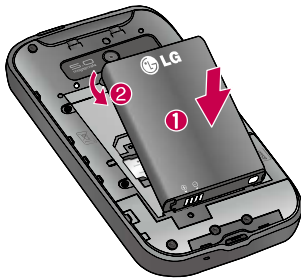

- 4 Replace the back cover of the phone.

Charging your phone

Slide open the cover of the charger connector on the side. Insert the charger, then plug it into an electrical outlet. Your LG-E510 must be charged before you see .

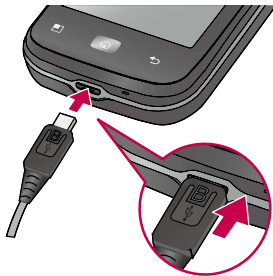

NOTE: The battery must be fully charged initially to improve battery lifetime.

Getting to know your phone

Installing the memory card

To store multimedia files, such as images captured using the built-in camera, you must insert a memory card into your phone.

NOTE: The LG-E510 supports memory cards up to 32 GB.

To insert a memory card:

- 1 Turn the phone off before inserting or removing a memory card. Remove the back cover.

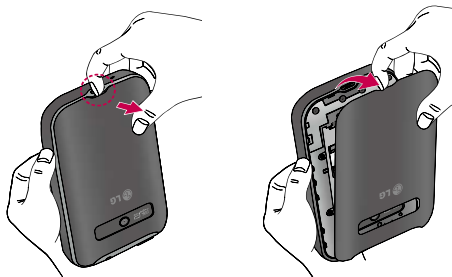

- 2 Insert the memory card into the slot. Make sure the gold contact area is facing downwards.

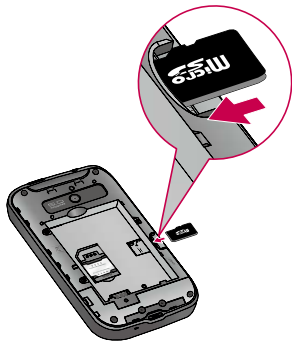

 **WARNING**

Do not insert or remove the memory card when the phone is on. Doing so may damage the memory card as well as your phone, and the data stored on the memory card may be corrupted.

Getting to know your phone

Formatting the memory card

Your memory card may already be formatted. If it isn't, you must format it before you can use it.

NOTE: All files on the card are deleted when you format the card.

- 1 In the Home screen, touch the **Applications** tab to open the applications menu.
- 2 Scroll to and touch **Settings > SD card & phone storage**, then select **Mass storage only**.

- 3 Touch **Unmount SD card** and touch **OK** to confirm.

- 4 Touch **Format SD card**, then confirm your choice.

- 5 If you have set a pattern lock, input the pattern lock then select **Erase everything**. The card is then formatted and ready to use.

NOTE: If there is content on your memory card, the folder structure may be different after formatting since all the files will have been deleted.

Your Home screen

Touch screen tips

Here are some tips on how to navigate around your phone.

Touch – To choose a menu/option or open an application, touch it.

Touch and hold – To open an options menu or grab an object you want to move, touch and hold it.

Drag – To scroll through a list or move slowly, drag across the touch screen.

Flick – To scroll through a list or move quickly, flick across the touch screen (drag quickly and release).

NOTE:

- To select an item, touch the centre of the icon.
- Do not press too hard; the touch screen is sensitive enough to pick up a light, firm touch.
- Use the tip of your finger to touch the option you want. Be careful not to touch any other keys.

Your Home screen

Lock your phone

When you are not using the LG-E510, press the power key to lock your phone. This helps prevent accidental presses and saves battery power.

Also, if you do not use the phone for a while, the Home screen or another screen you are viewing is replaced with the lock screen to conserve battery power.

If there are any programs running when you set the pattern, they may be still running in Lock mode. It is recommended that you exit all programs before entering the

Lock mode to avoid unnecessary charges (e.g. phone calls, Web access and data communications).

Setting an unlock pattern: you can draw your own unlock pattern by connecting the dots.

If you set a pattern, the phone screen locks. To unlock the phone, draw the pattern that you set on the screen.

Caution: When you set an unlock pattern, you need to create your Google mail account first.

Caution: If there are more than 5 pattern drawing errors in a row, you cannot unlock



the phone. In this case, your personal information and downloaded data is deleted.

Unlock screen

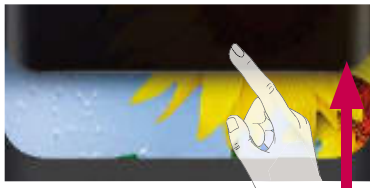
Whenever your LG-E510 is not in use, it returns to the lock screen. Drag your finger from bottom to top to unlock the screen.



Silent mode

In the notification drawer touch  , to change to  mode.

Home

Simply swipe your finger to the left or right to view the panels.

You can customise each panel with widgets, shortcuts (to your favourite applications), folders and wallpaper.

NOTE: Some screen images may be different depending on your phone provider.

Your Home screen

In your Home screen, you can view quick keys at the bottom of the screen. Quick keys provide easy, one-touch access to the functions you use the most.



Touch the **Phone** icon to bring up the touch screen dialpad to make a call.



Touch the **Contacts** icon to open your contacts.



Touch the **Messaging** icon to access the messaging menu. This is where you can create a new message.



Touch the **Applications** tab at the bottom of the screen. You can then view all

your installed applications.

To open the desired application, simply touch the icon in the applications list.

NOTE: Preloaded applications may differ according to your phone's software or your service provider.

Adding widgets to your Home screen

You can customise your Home screen by adding shortcuts, widgets or folders to it. For more convenience using your phone, add your favourite widgets to the Home screen.

- 1 In the Home screen, press the **Menu** key and select **Add**. Or touch and hold the empty part of the home screen.
- 2 In the **Edit mode** menu, touch the type of item you want to add.
- 3 For example, select **Folders** from the list and tap it.
- 4 You then see a new folder icon on the Home screen. Drag it to the desired location on the desired panel, then take your finger off the screen.

TIP! To add an application icon to the Home screen from the **Applications** menu, touch and hold the application you want to add.

TIP! To remove an application icon from the Home screen, touch and hold the icon you want to remove, then drag it to .

NOTE: You cannot delete preloaded applications. (Only their icons can be deleted from the screen)

Your Home screen

Returning to recently-used applications

- 1 Touch and hold the **Home** key. The screen displays a pop-up with icons of applications you used recently.
- 2 Touch an icon to open the application. Or touch the **Back** key to return to the current application.

Notification drawer

The notification drawer runs across the top of your screen.

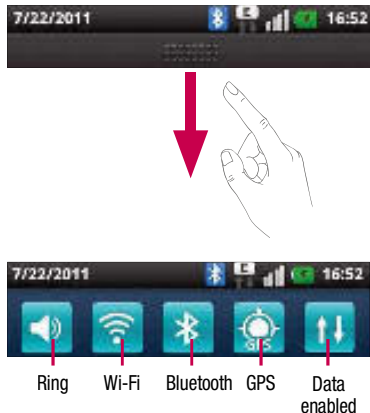

Touch and slide the notification drawer down with your finger.

Or, in the Home screen, press the **Menu** key and select **Notifications**. Here you can check and manage sound, Wi-Fi, Bluetooth and GPS as well as other notifications.

Viewing the status bar







The status bar uses different icons to display phone information such as signal strength, new messages, battery life and active Bluetooth and data connections.

Below is a table explaining the meaning of icons you're likely to see in the status bar.









[Status bar]





Your Home screen





Icon	Description
	No SIM card
	No signal
	Airplane mode
	Connected to a Wi-Fi network
	Wi-Fi Direct is on.
	Wired headset

Icon	Description
	Call in progress
	Call hold
	Speakerphone
	Phone microphone is muted
	Missed call
	Bluetooth is on

Icon	Description
	Connected to a Bluetooth device
	System warning
	Alarm is set
	New voicemail
	Ringer is silenced
	Vibrate mode



Icon	Description
	Battery fully charged
	Battery is charging
	Data in and out
	Phone is connected to PC via USB cable
	Downloading data

Icon	Description
	Uploading data
	GPS is acquiring
	Receiving location data from GPS
	On-Screen Phone connected
	3 more notifications not displayed

Icon	Description
	Data is syncing
	Download finished
	New Google mail
	New Google Talk message
	New message
	Song is playing

Your Home screen

Icon	Description
	Upcoming event
	FM radio turned on in the background
	SmartShare On
	SmartShare sharing request



Icon	Description
	USB tethering is active
	Portable Wi-Fi hotspot is active
	Both USB tethering and portable hotspot are active

Onscreen keyboard

You can enter text using the onscreen keyboard. The onscreen keyboard appears automatically on the screen when you need to enter text. To manually display the keyboard, simply touch a text field where you want to enter text.

Using the keypad & entering text

 Tap once to capitalise the next letter you type. Double tap for all caps.

  Tap to switch to the numeric and symbol keyboard. You can also touch and hold this tab to view the Settings menu.

 Tap to view or press and hold to change the writing language.

 Tap to insert an emoticon when writing a message.

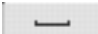
 Tap to enter a space.

 Tap to create a new line in the message field.

 Tap to delete the previous character.

 Tap to hide the onscreen keyboard.

Your Home screen

Entering accented letters

When you select French or Spanish as the text entry language, you can enter special French or Spanish characters (e.g. "á").

For example, to input "á", touch and hold the "a" key until the zoom-in key grows bigger and displays characters from different languages.

Then select the special character you want.

Google account setup

When you first turn on your phone, you have the opportunity to activate the network, to sign into your Google Account and how you want to use some Google services.

To set up your Google account :

* Sign into a Google Account from the prompted set up screen.

OR

* **Applications** > select a Google application, such as **Google Mail** > select **Next** > select **Create** to create a new account.

If you have a Google account, enter your e-mail address and password, then touch **Sign in**.

Once you have set up your Google account on your phone, your phone automatically synchronises with your Google account on the Web.

Your contacts, Google mail messages, Calendar events and other information from these applications and services on the Web are synchronised with your phone. (This depends on your synchronisation settings) .

Google account setup

After signing in, you can use Google mail™ and take advantage of Google services on your phone.

Wi-Fi

With Wi-Fi, you can use high-speed Internet access within the coverage of the wireless access point (AP).

Enjoy wireless Internet using Wi-Fi, without extra charges.

Turning on Wi-Fi

From the Home screen, open the notification drawer and touch .

Or touch **Applications** > **Settings** > **Wireless & networks**, then > **Wi-Fi** .

Connecting to Wi-Fi

Choose the Wi-Fi network you want to connect to. If you see , you need to enter a password to connect.

NOTE:

- If you are outside the Wi-Fi coverage area and choose 3G connection, additional charges may apply.
- If your phone goes into sleep mode when connected to Wi-Fi, the Wi-Fi connection is automatically disabled.
- In this case, if your phone has access to 3G data, it may connect to the 3G network_____

Wi-Fi



automatically and additional charges may apply.

- The LG-E510 supports WEP, WPA/WPA2-PSK and 802.1x EAP security. If your Wi-Fi service provider or network administrator sets encryption for network security, enter the key into the pop-up window. If encryption is not set, this pop-up window is not shown. Obtain the key from your Wi-Fi service provider or network administrator.

Sharing your phone's data connection

You can share your phone's mobile data connection with a single computer via a USB cable (USB tethering). You can also share your phone's data connection with up to five devices at a time by turning your phone into a portable Wi-Fi hotspot.

When your phone is sharing its data connection, an icon appears in the status bar and as an ongoing notification in the notifications drawer.

Icon	Description
	USB tethering is active
	Portable Wi-Fi hotspot is active
	Both USB tethering and portable hotspot are active

For the latest information about tethering and portable hotspots, including supported operating systems and other details, visit <http://www.android.com/tether>.

NOTE: Additional costs may be incurred when connecting and using online services. Check data charges with your network provider.

USB tethering & portable Wi-Fi hotspot settings

- 1 In the Home screen, touch the **Applications** tab and select **Settings**.
- 2 Touch **Wireless & networks** and select **Tethering & portable hotspot**.
- 3 Choose options that you want to adjust.

Wi-Fi

USB tethering – Tick to share your phone's mobile network data connection with your computer via a USB connection.

Portable Wi-Fi hotspot – Tick to share your phone's mobile network data connection as Wi-Fi sharing.

Help – Opens a dialog with information about USB tethering and portable Wi-Fi hotspots as well as information on where to learn more.

To share your phone's data connection via USB

If your computer is running Windows 7 or a recent distribution of some flavours of Linux (such as Ubuntu), you don't usually need to prepare your computer for tethering. But if you're running an earlier version of Windows or another operating system, you may need to prepare your computer to establish a network connection via USB. For the most current information about which operating systems support USB tethering and how to configure them, visit <http://www.android.com/tether>.

USB tethering and data sharing

You can't share your phone's data connection and microSD card via USB at the same time. If you are using your USB connection to make your microSD card available to your computer, you must disconnect it first.

- 1 Use the USB cable that came with your phone to connect your phone to your computer.
- 2 In the Home screen, touch the **Applications** tab and select **Settings**.

- 3 Touch **Wireless & networks** and select **Tethering & portable hotspot**.

- 4 Tick **USB tethering**.

- The phone starts sharing its mobile network data connection with your computer via the USB connection. An ongoing notification  is added to the status bar and notifications drawer.

- 5 Untick **USB tethering** to stop sharing your data connection. Or just disconnect the USB cable.

Wi-Fi

To share your phone's data connection as a portable Wi-Fi hotspot

- 1 In the Home screen, touch the **Applications** tab and select **Settings**.
- 2 Touch **Wireless & networks** and select **Tethering & portable hotspot**.
- 3 Tick **Portable Wi-Fi hotspot**.
 - After a moment, the phone starts broadcasting its Wi-Fi network name (SSID) so you can connect to it with up to eight computers or other devices. An

ongoing notification  is added to the status bar and notifications drawer.

- When **Portable Wi-Fi hotspot** is ticked, you can change its network name or secure it.
- 4 Untick **Portable Wi-Fi hotspot** to stop sharing your data connection via Wi-Fi.

To rename or secure your portable hotspot

You can change the name of your phone's Wi-Fi network name (SSID) and secure its Wi-Fi network.

- 1 In the Home screen, touch the **Applications** tab and select **Settings**.
 - 2 Touch **Wireless & networks** and select **Tethering & portable hotspot**.
 - 3 Ensure **Portable Wi-Fi hotspot** is ticked.
 - 4 Touch **Portable Wi-Fi hotspot settings**.
 - 5 Touch **Configure Wi-Fi hotspot**.
 - The **Configure Wi-Fi hotspot** dialog opens.
 - You can change the network SSID (name) that other computers see when scanning for Wi-Fi networks.
- You can also touch the **Security** menu to configure the network with Wi-Fi Protected Access 2 (WPA2) security, with a pre-shared key (PSK).
 - If you touch the **WPA2 PSK** security option, a password field is added to the **Configure Wi-Fi hotspot** dialog. If you enter a password, you will need to enter that password when you connect to the phone's hotspot with a computer or other device. Or touch **Open** in the **Security** menu to remove security from your Wi-Fi network.

Wi-Fi

ATTENTION!

If you set the security option as **Open**, you cannot prevent unauthorised usage of online services by other people and additional charges can be incurred. To avoid unauthorised usage, you are advised to keep the security option active.

6 Touch **Save**.

Enabling Wi-Fi Direct to share through SmartShare

Wi-Fi Direct cannot be enabled while using other Wi-Fi functions.

Wi-Fi Direct automatically scans nearby Wi-Fi Direct devices and the searched devices will be listed up in the order of arrival and you can select a specific device to share multimedia data through SmartShare.

- 1 On the home screen, touch the **Applications** tab and select **Settings**.
- 2 Touch **Wireless & networks** and select **Wi-Fi Direct settings**.

- 3 Ensure **Wi-Fi Direct** is selected.
- 4 Select a device to connect in the scanned device list.

Forced Group owner mode – Touch to activate group owner mode that enables the legacy Wi-Fi devices to connect by scanning your phone.

In this case you must enter the password that is set in the **Menu > Advanced > Password**.

NOTE: When your phone becomes group owner, it will consume more battery power than being a client. Wi-Fi Direct connection

does not provide Internet service. Additional cost may be incurred when connecting and using online services. Check data charges with your network provider.

Using the Wi-Fi Cast

You can share your music, picture and video contents between users who use Android Phone connected via same Wi-Fi & Wi-Fi Directed network.

Check your Wi-Fi & Wi-Fi Directed network in advance and make sure same network is connected between the users.

Wi-Fi

- 1 On the home screen, touch the **Applications** tab and select **Settings**.
- 2 Touch **Wireless & networks** and select **Wi-Fi Direct settings**.
- 3 Ensure **Wi-Fi Direct** is selected and select a device to connect in the scanned device list.
- 4 Touch **Connect**.

NOTE:

Wi-Fi cast is activated between the users.

Make sure to connect to same Wi-Fi Network between the users.

On-Screen Phone

How to use On-Screen Phone

On-Screen Phone allows you to view your mobile phone screen from a PC via a USB or Bluetooth connection.

You can also control your mobile phone from your PC using the mouse or keyboard.

On-Screen Phone icons



Connects your mobile phone to your PC, or disconnects it.



Rotates the On-Screen Phone window (only available at applications that support rotation).



Changes the On-Screen Phone preferences.



Exits the On-Screen Phone program.



Minimises the On-Screen Phone window.

On-Screen Phone features

- Real-time transfer and control: displays and controls your mobile phone screen when connected to your PC.
- Mouse control: allows you to control your mobile phone by using the mouse to click and drag on your PC screen.

On-Screen Phone

- Text input with keyboard: allows you to compose a text message or note using your computer keyboard.
- File transfer (mobile phone to PC): sends a file from your mobile phone (e.g. photos, videos, music and Polaris viewer files) to your PC. Simply right-click and drag to send a file to your PC.
- File transfer (PC to mobile phone): sends files from your PC to your mobile phone. Simply select the files you wish to transfer and drag and drop into the On-Screen Phone window. The files you send are

stored on a micro SD card.

- Real-time event notifications: prompts a pop-up to inform you of any incoming calls or text, as well as alarm and event notifications.

How to install On-Screen Phone on your PC

If you install LG PC Suite IV, the On-Screen Phone program will also be downloaded on your PC. Then you can install the On-Screen Phone on your PC.

How to connect your mobile phone to your PC

USB connection:

- 1 Open Connection Wizard, select "USB Cable connection" and click "Next".
- 2 Connect your mobile phone to the PC using a USB cable and click "Next".
- 3 Enter the On-Screen Phone password and click "Next". The default password is "0000". You can change the password in **Settings > Wireless & networks > On-Screen Phone settings**.

- 4 Click "OK" to exit the window.

NOTE: Go to **Settings > SD card & phone storage** and make sure that the "Mass storage only" checkbox is deselected.

Wireless connection with Bluetooth:

- 1 On your mobile phone, go to **Settings > Wireless & networks > Bluetooth settings**. Select **Turn on Bluetooth** and select **Discoverable**.
- 2 If you have previously connected using a cable, run the New Connection Wizard to create a new connection.

On-Screen Phone

- 3 Run the Connection Wizard on the computer, select "Bluetooth connection", then "Next".
- 4 The wizard starts searching for Bluetooth-enabled mobile phones. When the mobile phone that you wish to connect to appears, click "Stop" to stop searching.
- 5 Select "LG-E510" from the device list and click "Next". You can rename the device if you wish.
- 6 Enter the PIN code (e.g. "0000") and click "Next".
- 7 On your mobile phone, accept the request and check the same PIN code, then touch "OK".
- 8 Enter the On-Screen Phone password and click "Next" (the default password is "0000").
- 9 Touch "OK" to exit.

To check the phone to PC connection

Once the devices have been connected, drag down the notification bar at the top of the home screen to check the On-Screen Phone connection status.





To disconnect your phone from your PC

Click  in the top left of the On-Screen Phone window. Or drag down the notification bar at the top of the home screen and select "On-Screen Phone". Touch "Yes" in the Disconnect window.

NOTE: You must restart your phone after shutting down the On-Screen Phone service.

Calls

Making a call

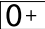

- 1 Touch  to open the keypad.
- 2 Enter the number using the keypad. To delete a digit, touch the **Clear** icon .
- 3 Touch the **Call** icon  to make a call.
- 4 To end a call, touch the **End** icon .

TIP! To enter “+” to make international calls, touch and hold .

Calling your contacts

- 1 Touch  to open your contacts.
- 2 Scroll through the contact list or enter the first letter(s) of the contact you want to call by touching **Search**.
- 3 In the list, touch the contact which you want to call and tap on the number or call icon to make call.

Answering and rejecting a call

When the Screen is locked and your phone rings, drag the **Answer** icon  to the right. Drag the **Decline** icon  to the left to

reject an incoming call. Drag the **Excuse messages** bar from the bottom if you want to send one. If the caller is unknown, the **Excuse messages** bar is not available.



TIP! Excuse messages

When you reject a call, you can send a message quickly by touching Send SMS. This is useful if you need to reply the message during a meeting.

Adjusting call volume

To adjust the in-call volume during a call, use the Volume Up and Down key on the left side of the phone.

Making a second call

- 1** During your initial call, tap on the **Menu** and select .
- 2** Dial the number, or search your contacts.
- 3** Touch the **Call** icon  to connect the call.
- 4** Both calls are displayed on the call screen. Your initial call is locked and put on hold.
- 5** Touch the displayed number to toggle between calls. Or touch  **Merge call** to make a conference call.
- 6** To end active calls, touch **End**.

Calls

NOTE: You are charged for each call you make.

Viewing your call logs

In the Home screen, touch  and choose the **Call log** tab.

View a complete list of all dialled, received and missed voice calls.

TIP! Touch any call log entry to view the date, time and duration of the call.

TIP! Press the **Menu** key, then touch **Delete All** to delete all the recorded items.

Call settings

You can configure phone call settings such as call forwarding and other special features offered by your carrier.

- 1 In the Home screen, touch the **Applications** tab to open the applications menu.
- 2 Scroll and touch **Settings**.
- 3 Tap **Call settings** and choose the options that you want to adjust.

Contacts



Add contacts to your phone and synchronise them with the contacts in your Google account or other accounts that support contact syncing.

Searching for a contact

In the Home screen

- 1 Touch  to open your contacts.
- 2 Touch **Search** and enter the contact name using the keyboard.

Adding a new contact

- 1 Touch , enter the new contact's number, then press the **Menu** key. Touch **Add to contacts** and then **Create new contact**.
- 2 If you want to add a picture to the new contact, touch . Choose from **Capture picture** or **Pick from gallery**.
- 3 Select the contact type by touching .
- 4 Touch a category of contact information and enter the details about your contact.
- 5 Touch **Save**.

Contacts

Favorite contacts

You can classify frequently called contacts as favorites.

Adding a contact to your favorites

- 1 Touch  to open your contacts.
- 2 Touch a contact to view its details.
- 3 Touch the star to the right of the contact's name. The star turns gold.

Removing a contact from your favorites list

- 1 Touch  to open your contacts.
- 2 Touch the **Groups** tab, select **Favorites** at the top of the list and choose a contact to view its details.
- 3 Touch the Gold star to the right of the contact's name. The star turns grey and the contact is removed from your favourites.

Moving contacts from your old phone to your new phone

Export your contacts as a CSV file from your old phone to your PC using a PC sync program.

- 1 Download PC Suite IV from www.lg.com and install it on the PC. Run the program and connect your Android mobile phone to the PC using the USB cable.
- 2 Select the **Contacts** icon. Go to **Menu > More > Import/Export** and select the CSV file saved on your PC.
- 3 If the fields in the imported CSV file are different from those in PC Suite IV, you need to map the fields. After mapping the fields, click OK. The contacts are then added to PC Suite IV.
- 4 If PC Suite IV detects the connection of your LG-E510 phone (using the USB cable), click Sync or Sync contacts to synchronise the contacts saved on your PC with your phone.

Messaging/E-mail

Messaging

Your LG-E510 combines SMS and MMS into one intuitive, easy-to-use menu.

Sending a message

- 1 Touch  icon on the home screen, and touch **New Message** to open a blank message.
- 2 Enter a contact name or contact number in the **To** field. As you enter the contact name, matching contacts appear. You can touch a suggested recipient. You can add multiple contacts.

NOTE: You will be charged for a text message for every person you send the message to.

- 3 Touch Enter message field and start to compose your message.
- 4 Press the **Menu** key to open the options menu. Choose from **Call, Add subject, Discard, Reply by, Attach, More**.
- 5 Touch **Send** to send your message.
- 6 The message screen opens, with your message after Recipient Name/Number. Responses appear on the screen. As you view and send additional messages, a message thread is created.



WARNING: The 160-character limit may vary from country to country depending on how the SMS is coded and in what language.



WARNING: If an image, video or audio file is added to an SMS, it will be automatically converted into an MMS , and you will be charged accordingly.

NOTE: When you get an SMS message during a call, there will be a ring notification.

Threaded box

Messages (SMS, MMS) exchanged with another party can be displayed in chronological order so that you can conveniently see an overview of your conversation.

Using Smilies

Liven up your messages using Smilies.

When writing a new message, press the **Menu** key, then choose **Insert smiley**.

Messaging/E-mail

Changing your message settings

Your LG-E510 message settings are predefined, so you can send messages immediately. You can change the settings based on your preferences.



WARNING: In this mode, the MMS Client device guides the user in creating and sending messages with content belonging to the Core MM Content Domain. This guidance is provided through warning dialogs.

Opening Email and the Accounts Screen

You can use the **E-mail** application to read email from services other than Google Mail. The Email application supports the following account types: POP3, IMAP and Exchange.

To open the Email application

From the Home screen, touch Application-> Email Select Email Service Provider.

A setup wizard opens to help you add an email account. After the initial setup, Email displays the contents of your Inbox (if you

have only one account) or the Accounts screen (if you have multiple accounts).

The Accounts screen

The Accounts screen lists your Combined Inbox and each of your email accounts.

1 Open the **E-mail** application. If you're not on the Account screen, press the **Menu Key** and touch **Accounts**.

2 Select the Email service provider.



- Touch to open your Combined Inbox, with messages Recieved to all of your accounts.



- Touch to open a list of just your starred messages.



- Touch the folder icon to open the account's folders.

You can touch an account to view its Inbox. The account from which you send email by default is indicated with a tick.

To open your Combined Inbox

If you have configured Email to send and receive email from more than one account, you can view all messages sent to all accounts in your Combined Inbox.

Messaging/E-mail

- 1 Touch **E-mail**.
- 2 Touch **Combined Inbox** (in the Accounts screen). Messages in the Combined Inbox are colour coded along their left sides, by account, using the same colours that are used for your accounts in the Accounts screen.

Only your account's most recent emails are downloaded to your phone. To download more (earlier) email messages, touch **Load more messages** at the bottom of the emails list.

Composing and Sending Email

To compose and send a message

- 1 While in the **E-mail** application, press the **Menu** Key and touch **Compose**.
- 2 Enter an address for the message's intended recipient. As you enter text, matching addresses are offered from your Contacts. Separate multiple addresses with commas.
- 3 Touch the **Menu** key and then touch **Add Cc/Bcc** to send copy or blind copy of the mail to other contacts/email addresses.
- 4 Enter the text of the message.

5 Press the **Menu** Key and touch **Add attachment** to send a file with the message.

6 Touch the **Send** button.

If you're not ready to send the message, touch the **Save as draft** button to save it in a **Drafts** folder. Touch a draft message in a **Drafts** folder to resume working on it. Your message will also be saved as a draft if you touch the **Back Key**  before sending it. Touch the **Discard** button to abandon and delete a message, including any saved drafts. If you aren't

connected to a network, for example, if you're working in airplane mode, the messages that you send are stored in your **Outbox** folder until you're connected to a network again. If it contains any pending messages, the **Outbox** is displayed on the Accounts screen.

Please note that messages sent using an Exchange account will not be located on the phone; they will, however, be located on the Exchange server itself.

If you want to see your sent messages in the **Sent** folder, then touch Menu key and touch

Messaging/E-mail

on Folders then touch on **Sent** folder and select **Refresh** from the options Menu.

TIP! When a new email arrives in the inbox, you will receive a notification by sound or vibration.

Working with Account Folders

Each account has **Inbox**, **Outbox**, **Sent**, and **Drafts** folders. Depending on the features supported by your account's service provider, you may have additional folders.

Adding and Editing email Accounts

- 1 To add an email account Touch the Applications tab and select Email.
- 2 Select **Microsoft Exchange** or Others, and enter account settings.
- 3 If an email account is already set up, you need to touch the **Menu** key then tap **Add account** from Accounts Screen.
- 4 Enter a name for the account, confirm how you want your name to appear in outgoing mail, then touch the **Done** button.

To change an account's settings

- 1 Open the **Accounts** screen.
- 2 Touch and hold the account whose settings you want to change. In the menu that opens, touch **Account settings**.

To delete an email account

- 1 Open the Accounts screen.
- 2 Touch and hold the account you want to delete.
- 3 Touch **Remove account** in the menu that opens.
- 4 Touch the **OK** button in the dialog box to confirm that you want to delete the account.

Social Networking

Social Networking

With your phone, you can take advantage of Social Networking and manage your micro-blog in on-line communities. You can update your current status, upload photos, and view your friend's status updates in real-time.

You can add your Facebook, Twitter and Myspace accounts to your phone. If you don't have an account, you can visit their sites to set it up.

NOTE: Additional costs may be incurred when connecting and using online services. Check your data charges with your network provider.

Adding your account to your phone

- 1 Touch and hold the home screen. When various Widgets appear, choose Social+  and tap the Setting  button. You can also access in a different way, on the home screen, choose **Applications > Settings > Accounts & sync > Social+ settings**.
- 2 Choose the Social Networking client application you want to use from Facebook for LG, Twitter for LG and MySpace for LG.

- 3 Enter your community email address and password, then tap Log in.
- 4 Wait while your details are confirmed with your community.
- 5 If you tap your community, you can see its current status.

TIP! If you add a Social Networking widget on your home screen, the widget will show your status when your phone updates from the network. You can also access the social community directly by touching the widget.

Viewing and updating your status

- 1 You can view and update social community content using the Social+ widget at any time.
- 2 On the Social+ widget, choose the Social Networking service which you want to log in. You will then see your status and contents.
- 3 When you touch the input box, the screen will switch to update your current status with comments or upload photos.

Social Networking

TIP! You can update your status and upload photos simultaneously to Facebook for LG, Twitter for LG and MySpace for LG by selecting the checkbox.

NOTE: This depends on network services.

TIP! You can synchronise your friend contact to your contact list.

Removing accounts from your phone

Choose **Settings** > **Accounts & sync** >
Choose an account you want to delete >
Touch **Remove account**.

Camera

Getting to know the viewfinder

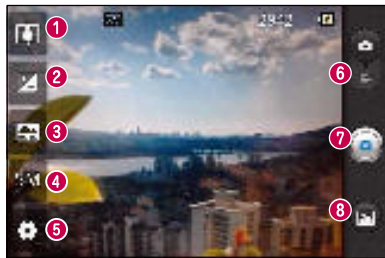

TIP! You can close all the shortcut options to give a clearer viewfinder screen by touching the centre of the viewfinder once. To display the options, touch the screen again.

- 1 Zoom** - Zoom in or zoom out. Alternatively you can use the side volume keys.
- 2 Brightness** - This defines and controls the amount of sunlight entering the image. Slide the brightness indicator along the bar towards “-” to lower the brightness of the image or towards “+” to increase it.
- 3 Scene mode** - Choose from **Auto, Portrait, Landscape, Sports, Night** and **Sunset**.
- 4 Image size** - Touch to set the size (in pixels) of the picture you take.
- 5 Settings** - Touch this icon to open the Settings menu. See 'Using the advanced settings'.
- 6 Video mode** - Slide this icon down to switch to video mode.
- 7 Taking a photo**
- 8 Gallery** - Touch to view the last photo you captured. This enables you to access your gallery and view saved photos from within camera mode.

Camera

Taking a quick photo

- 1 Open the **Camera** application.
- 2 Hold the phone horizontally and point the lens towards the subject you want to photograph.
- 3 In the centre of the viewfinder screen, a focus box starts blinking as it tries to get the subject in focus.
- 4 The focus box turns green when the subject is in focus.
- 5 Press the capture  button. You can press the capture button whether the focus box is green or not.

Once you've taken the photo

Your captured photo appears on the screen.

Share

Touch to share your photo using **SmartShare, Bluetooth, Google Mail, Messaging, Picasa, Social+** or **Wi-Fi Cast**.

NOTE: additional charges may apply when MMS messages are downloaded while roaming.

TIP! If you have an SNS account and set it up on your phone, you can share your photo with the SNS community.

Set as Touch to use the image as a **Contact icon** or **Wallpaper**.

Rename Touch to edit the name of the picture just taken.

 Touch to delete the image.

 Touch to take another photo immediately. Your current photo is saved.

 Touch to view the last photo you captured as well as the gallery

Using the advanced settings

In the viewfinder, touch  to open all advanced options.

Change camera settings by scrolling through the list. After selecting the option, touch the **Back** key.

ISO – The ISO rating determines the sensitivity of the camera's light sensor. The higher the ISO, the more sensitive the

Camera

camera is. This is useful in darker conditions when you cannot use the flash. Select from ISO values of **Auto**, **400**, **200** and **100**.

White balance – Choose from **Auto**, **Incandescent**, **Sunny**, **Fluorescent** and **Cloudy**.

Color effect – Choose a colour tone for your new photo.

Timer – The self-timer allows you to set a delay after the capture button is pressed. Select **Off**, **3 secs.**, **5 secs.** or **10 secs.** This is ideal if you want to be in the photo.

Image quality – Choose from **Super fine**, **Fine** and **Normal**. The finer the quality, the sharper the photo. However, the file size increases as a result, which means you can store fewer photos in the memory.



Auto review – If you turn **Auto review** on, it automatically shows you the picture you just took.

Shutter sound – Select one of four shutter sounds.

Tag location – Activate to use your phone's location-based services. Take pictures wherever you are and tag them with the

location. If you upload tagged pictures to a blog that supports geotagging, you can see the pictures displayed on a map.

NOTE: This function is only available when GPS is active.

-  – Restore all camera default settings.
-  – Touch whenever you want to know how this function operates. This provides you with a quick guide.

TIP! When you exit the camera, some settings return to their defaults, such as white balance, color effect and timer . Check these before you take your next photo.

TIP! The Settings menu is superimposed over the viewfinder, so when you change elements of the image colour or quality, you see a preview of the image change behind the Settings menu.

Viewing your saved photos

Access your saved photos while in **Camera** mode. Just touch  and touch the screen. You then see **Slideshow** and **Menu**.

TIP! Flick left or right to view other photos or videos.



- Touch to see a slideshow.



- Touch to share the contents or delete a photo. Touch **More** for more options.

Details – Check information on the content.

Set as – Set as a contact icon or wallpaper.

Crop – Crop your photo. Move your finger across the screen to select the area.

Rotate Left/Rotate Right – Rotate left or right.

Video camera



Getting to know the viewfinder



- 1 Zoom** - Zoom in or zoom out. Alternatively you can use the side volume keys.
- 2 Brightness** - This defines and controls the amount of sunlight entering the video. Slide the brightness indicator along the bar towards “-” to lower the brightness of the video or towards “+” to increase it.
- 3 Video size** - Touch to set the size (in pixels) of the video you record.
- 4 Duration** - Set a duration limit for your video. Choose between Normal and MMS to limit the maximum size to send as an MMS message.
- 5 Settings** - Touch this icon to open the settings menu. See 'Using the advanced settings'.
- 6 Camera mode** - Slide this icon up to switch to camera mode.
- 7 Start recording**
- 8 Gallery** - Touch to view the last video you recorded. This enables you to access your gallery and view your saved videos from within video mode.

Video camera

Shooting a quick video

- 1 Slide the **Camera** mode button down and the icon changes to .
- 2 The video camera viewfinder appears on the screen.
- 3 Holding the phone horizontally, point the lens towards the subject you want to capture in your video.
- 4 Press the Record  button once to start recording.
- 5 REC appears at the bottom of the viewfinder with a timer showing the length of the video.

- 6 Touch  on the screen to stop recording.

After shooting a video

A still image representing your video will appear on the screen.

Play

Touch to play the video.

Share

Touch to share your video using **SmartShare, Bluetooth, Google Mail, Messaging, Wi-Fi Cast** or **YouTube**.

NOTE: Additional charges may apply when MMS messages are downloaded while roaming.

Rename Touch to edit the name of the selected video.

 Touch to shoot another video right away. Your current video is saved.

 Touch to delete the video you just made. Confirm by touching **OK**. The viewfinder reappears.

 Touch to view the last recorded video as well as the gallery.

Using the advanced settings

Using the viewfinder, touch  to open all the advanced options.

Adjust the video camera setting by scrolling through the list. After selecting the option, touch the **Back** key.

White balance – White balance ensures that the white areas in your video are realistic. To enable your camera to adjust the white balance correctly, you may need to determine the light conditions. Choose from **Auto**, **Incandescent**, **Sunny**, **Fluorescent** and **Cloudy**.

Video camera

Color effect – Choose a colour tone to use for your new view.

Video quality – Choose from **Super fine**, **Fine** and **Normal**.

Audio recording – Choose **Mute** to record a video without sound.

Auto review – Auto review automatically shows you the video you just recorded.

 – Restore all video camera default settings.

 – Touch if you want to know how this function operates. This provides you with a quick guide.

Watching your saved videos

- 1 In the viewfinder, touch .
- 2 Your gallery appears on the screen.
- 3 Touch a video once to bring it to the front of the gallery. It starts playing automatically.

Adjusting the volume when viewing a video

To adjust the volume of a video while it is playing, use the volume keys on the left-hand side of the phone.

Multimedia

You can store multimedia files on a memory card to have easy access to all your image and video files.

Touch the **Applications** tab, then select **Gallery**. Open a list of catalogue bars that store all your multimedia files.

NOTE: Make sure you install a memory card in the phone to save photos and videos. Without a memory card, the phone does not display photos or videos except Picasa images, which are in your Picasa web album.

View mode

Touch **Gallery**. Folder view is displayed.

Touch any folder and it turns to grid view mode. If you tap a photo, it changes into full view mode.

Timeline view

LG-E510 **Gallery** provides a timeline view of your photos and videos. In grid view mode, drag  to the right and the date you took your photos is displayed, starting with the most recent. If you select a specific date, all the photos you took on that day are grouped.

Multimedia

Using SmartShare

SmartShare provides you with a better way to enjoy multimedia contents with other DLNA (Digital Living Network Alliance) enabled devices.

* Share your media contents with other DLNA devices (DMS)

- 1 In the Home screen, touch the **Applications** tab and select **SmartShare**.
- 2 Press the **Menu** key and select **Settings**.
- 3 Touch the Discoverable tickbox to turn on.

- 4 You can change your device name, icon and select the sharing content types.

* Let your renderer device (e.g. TV) play multimedia contents from remote content library (e.g. PC)

- 1 Touch the top right button to select the device from a list of renderers.
- 2 Touch the top left button and select a remote content library.
- 3 You can browse the remote content library.
- 4 Touch a content thumbnail or press the **Menu** key and select the Play button.





Notice: Check that your device is connected to your home network using a Wi-Fi connection in order to use this application.

Notice: Some DLNA-enabled devices (e.g. TV) support only DMP features of DLNA and will not appear in the renderer device lists.

Music

Your LG-E510 has a built-in music player that lets you play all your favourite tracks. To access the music player, touch **Music**.

Playing a song

- 1 In the Home screen, touch the **Applications** tab and select **Music**.
- 2 Touch **Songs**.
- 3 Select the song you want to play.
- 4 Touch  to pause the song.
- 5 Touch  to skip to the next song.
- 6 Touch  to go back to the beginning of the song. Touch  twice to return to the previous song.

Multimedia

To change the volume while listening to music, press the up and down volume keys on the left-hand side of the phone.

Touch and hold any song in the list. It displays **Play, Add to playlist, Use as phone ringtone, Delete, Details, Share** and **Search** as options.

NOTE: Music file copyrights may be protected by international treaties and national copyright laws.

Therefore, it may be necessary to obtain permission or a licence to reproduce or copy music.

In some countries, national laws prohibit private copying of copyrighted material. Before downloading or copying the file, check the national laws of the relevant country concerning the use of such material.

Transferring files using USB mass storage devices

To transfer files using USB devices

- 1 Connect the LG-E510 to a PC using a USB cable.
- 2 If you haven't installed LG Android Platform Driver on your PC, you need to change the settings manually. Choose **Settings > SD card & phone storage**, then select **Mass storage only**.
- 3 Touch **Turn on USB storage**.
- 4 You can view the mass storage contents on your PC and transfer the files.

NOTE: You need to install an SD card first. Without an SD card, you cannot use USB mass storage.

NOTE: If you installed LG Android Platform Driver, you will immediately see a pop-up saying Turn on USB storage.

How to Transfer music/video files to your phone

- 1 Connect your phone to the PC using the USB cable. In the Home screen, touch and drag down the notification drawer. Select **USB connected > Turn on USB storage > Select Open folder to view**

Multimedia

files from Removable Disk pop up which appears in PC .

If you didn't install LG Android Platform Driver on your PC, you must set it up manually.

For more information, refer to 'Transferring files using USB mass storage devices'.

2 Transfer music or video files from the PC to the phone's removable storage.

- You can copy or move files from your PC to your phone's removable storage using a card reader.

- If there is a video file with a subtitle file (*.srt file with the same name as the video file), place it in the same folder to display subtitles automatically when playing the video file.
- When downloading music or video files, copyrights must be secured. Note that corrupted files or files with incorrect extensions may damage your phone.

Sending data from your phone using Bluetooth

Sending data using Bluetooth You can use Bluetooth to send data by running a

corresponding application, not from the Bluetooth menu as on most other mobile phones.

- * **Sending pictures:** Run the Gallery application, then select **Picture > Menu**. Click **Share**, then select **Bluetooth**. Check whether Bluetooth is turned on, then select **Scan for devices**. Choose the device you want to send data to from the list.
- * **Exporting contacts:** Run the Contacts application. Touch the address you want to export to. Press the **Menu** key and select **Share > Bluetooth**. Check whether

Bluetooth is turned on, then select **Scan for devices**. Choose the device you want to send data to from the list.

- * **Sending multi-selected contacts:** Run the Contacts application. To select more than one contact touch the **Menu** key and touch Share. Select the contacts you want to send or touch **Select all** option from top > Select **Share > Bluetooth > Enable Bluetooth** and select **Scan for devices >** Choose the device you want to send data from the list.

Multimedia

- * **Connecting to FTP (only FTP server is supported on this handset):** select **Settings > Wireless & networks > Bluetooth settings**. Select the **Discoverable** box so you can search for your phone on other devices. Find the FTP service and connect to the FTP server.
- If you want to search for this phone from other devices, go to **Settings > Wireless & networks > Bluetooth settings**. Select the **Discoverable** box. The box is cleared after 120 seconds.

FM Radio

Your LG-E510 has a built-in FM radio so you can tune in to your favourite stations and listen on the go.

NOTE: You must attach your headphone to listen to the radio. Insert it into the headphone jack.

Searching for stations

You can tune in to radio stations by searching for them manually or automatically. They will be then saved to specific channel numbers, so you don't have to keep re-tuning it.

You can store up to 48 channels on your phone.

Tuning in automatically

- 1 In the Home screen, touch the **Applications** tab and select **FM Radio**.
- 2 Press the **Menu** key, then touch **Auto scan**.
- 3 If there are preset channels, you will see a pop-up asking "Reset all channels and start auto scan?". If you choose OK, all the preset channels are deleted and **Auto scan** starts.

- 4 During auto scanning, touch **Stop** if you want to stop scanning. Only scanned channels are saved before you stop scanning.

NOTE: You can also manually tune in to a station using the displayed wheel.

Resetting channels

Press the **Menu** key and choose **Reset channel** to reset the current channel, or choose **Reset all channels** to reset all the channels.

Multimedia

Listening to the radio

- 1 On the home screen, touch Applications tab and select FM radio.
- 2 Touch the channel number of the station you want to listen to.
- 3 Touch **Listen Via** to set the mode to speaker or headset to listen to the radio.
- 4 Touch  icon for volume.

TIP! To improve radio reception, extend the headset cord as this also functions as the radio antenna.

WARNING

If you connect a headset not specifically made for radio reception, radio reception may be poor.

Utilities

Setting your alarm

- 1 In the Home screen, touch the **Applications** tab and select **Clock**.
- 2 If you want to add a new alarm, touch  and select **Add Alarm**.
- 3 Set the time to turn on the alarm. After you set the time, the LG-E510 lets you know how much time is left before the alarm will sound.
- 4 Set **Repeat**, **Ringtone** or **Vibrate**, then add a label to name the alarm. Touch **Done**.

NOTE: to change alarm settings on alarm list screen, press the **Menu** key and select **Settings**. You can adjust the below options: **Alarm in silent mode**, **Alarm volume**, **Snooze duration** and **Side button behavior**.

Using your calculator

- 1 In the Home screen, touch the **Applications** tab and select **Calculator**.
- 2 Touch the number keys to enter numbers.
- 3 For simple calculations, touch the function you want (+, -, x or ÷) followed by =.

Utilities

- 4 For more complex calculations, press the **Menu** key, touch the **Advanced panel**, then choose sin, cos, tan, log and so on.

Adding an event to your calendar

- 1 In the Home screen, touch the **Applications** tab and select **Calendar**.
- 2 To check the event, touch the date. Touch and hold if you want to add a new event. Touch **New event**.
- 3 Touch **What** then enter the event name. Check the date and enter the time you

want your event to start and finish.

- 4 Also, touch **Where** then enter the location.
- 5 If you want to add a note to your event, touch **Description** and enter the details.
- 6 If you want to repeat the alarm, set **Repetition**, and set **Reminders**, if necessary.
- 7 Touch **Done** to save the event in the calendar. A coloured square in the calendar marks all days that have saved events. An alarm sounds at the event start time to help you stay organised.

Changing your calendar view

- 1 In the Home screen, touch the **Applications** tab and select **Calendar**. Press the **Menu** key.
- 2 Select the calendar view for a particular day, week or month.

Polaris Viewer

Polaris Viewer is a professional mobile office solution that lets users conveniently view various types of office documents, including Word, Excel and PowerPoint files, anywhere, anytime, using their mobile devices.

Managing files

Polaris Viewer provides mobile users with convenient file management features, including copying, moving, renaming and deleting files and folders right on the device and sending files from the device.

Viewing files





Mobile users can now easily view a wide variety of file types, including Microsoft Office documents and Adobe PDF, right on their mobile devices. When viewing documents using Polaris Viewer, the objects and layout remain the same as in their original documents.

Utilities

Voice recorder

Use the voice recorder to record voice memos or other audio files.

Recording a sound or voice

- 1 In the Home screen, touch the **Applications** tab and select **Voice Recorder**.
 - 2 Touch  to begin recording.
 - 3 Touch  to end the recording.
 - 4 Touch  to listen to the recording.
- NOTE:** touch  to access your album. You can listen to the saved recording.

Notice: the available recording time may differ from the real time.

Sending the voice recording

- 1 Once you have finished recording, you can send the audio clip by touching **Share**.
- 2 Choose from **Bluetooth**, **E-mail**, **Google Mail Messaging** and **Wi-Fi Cast**. When you select **E-mail**, **Google Mail** and **Messaging**, the voice recording is added to the message, then you write and send the message normally.

The Web

Browser

Browser gives you a fast, full-colour world of games, music, news, sport, entertainment and much more, right on your mobile phone. Wherever you are and whatever you enjoy.

NOTE: additional charges apply when connecting to these services and downloading content. Check data charges with your network provider.

Using the web toolbar



Touch to go backwards one page.



Touch to go forwards one page to the one you connected to after the current page. This is the opposite of what happens when you press the **Back** key, which goes to the previous page.



Touch to show all your open windows.



Touch to add a new window



Touch to change web browser settings.



Add/show bookmark and show **Most visited**, **Read it later** and **History**.

The Web

Using options

Press the **Menu** key to view options.

 **Read it later** – Add the current web page as a bookmark.

 **Add RSS Feed** – Add the current web page to the RSS feed.

 **Share page** – Allows you to share the web page with others.

 **Find on page** – Allows you to find letters or words on the current web page.

 **Select text** – allows you to copy any text from the web page.

 **More**

- **Home page:** Go to the Home page.
- **Set home page:** Set the current web page as your Home page.
- **Add shortcut to Home:** Add the shortcut of the current web page to the Home screen.
- **Page info:** Displays the web page information.

- **Downloads:** Displays your download history.

TIP To return to the previous web page, press the **Back** key.

Settings

In the Home screen, touch the **Applications** tab then scroll to and touch **Settings**.

Wireless & networks

Here, you can manage Wi-Fi and Bluetooth. You can also set up mobile networks and switch to airplane mode.

Airplane mode – After switching to airplane mode, all wireless connections are disabled.

Wi-Fi – Touch to select: This turns on Wi-Fi to connect to available Wi-Fi networks.

Wi-Fi settings – Allows you to set up and manage wireless access points. Set network

notification, or add a Wi-Fi network. The advanced Wi-Fi settings screen is accessed from the Wi-Fi settings screen. Press the **Menu** key and touch **Advanced**.

Wi-Fi Direct settings – Set Wi-Fi Direct device name and scan for other devices. Or be a Group owner to allow legacy Wi-Fi devices to connect.

TIP! How to obtain the MAC address

To set up a connection in some wireless networks with MAC filters, you may need to enter the MAC address of your LG-E510 into the router.

You can find the MAC address in the following user interface: Touch **Applications > Settings > Wireless & networks > Wi-Fi settings**, and press the **Menu** key. Then select **Advanced > MAC address**.

Bluetooth – Touch to select: This turns on Bluetooth to connect to Bluetooth devices.

Bluetooth settings – Set device name & discoverable mode, scan for other devices. Or, check a list of Bluetooth devices that you've previously configured and those detected when the phone last scanned for Bluetooth devices.

Tethering & portable hotspot – You can configure the USB tethering and portable Wi-Fi hotspot settings.

VPN settings – Displays the list of Virtual Private Networks (VPNs) that you've

Settings

previously configured. Allows you to add different types of VPN.

Mobile networks – Set options for data roaming, network mode & operators, access point names (APNs) and so on.

On-Screen Phone settings – Allows you to change the On-Screen Phone password (the default password is "0000"). On-Screen Phone allows you to view your mobile phone screen from a PC via a USB or Bluetooth connection. You can also control your mobile phone from your PC using the mouse or keyboard.

Call settings

< Fixed dialing numbers >

Select **Fixed dialing numbers** to turn on and compile a list of numbers that can be called from your phone. You'll need your PIN2, which is available from your operator. Only numbers within the fixed dial list can be called from your phone.

< Voicemail >

Voicemail service – Allows you to select your carrier's voicemail service.

Voicemail settings – If you are using your carrier's voicemail service, this option allows

you to enter the phone number to use for listening to and managing your voicemail.

< **Other call settings** >

Excuse messages – When you want to reject a call, you can send a quick message using this function. This is useful if you need to reject a call during a meeting.

Call forwarding – Choose whether to divert all calls, when the line is busy, when there is no answer or when you have no signal.

Call barring – Select when you would like calls to be barred. Enter the call barring password. Please check with your network

operator about this service.

Call reject – Allows you to set the call reject function. Choose from **Off**, **Reject on list** or **Reject all calls**.

Call costs – View the charges applied to your calls. (This service is network dependent; some operators do not support this function)

Call duration – View the duration of calls including last call, all calls, dialled calls and received calls.

Additional settings – This lets you change the following settings:

Settings

Caller ID: Choose whether to display your number on an outgoing call.

Call waiting: If call waiting is activated, the handset will notify you of an incoming call while you are on another call (depending on your network provider).

Sound

< General >

Silent mode – Allows you to mute all sounds (including call and notification ringtones) except the audio from music and videos and any alarms you have set. You

must mute media and alarm sounds in their own applications.

Vibrate – Allows you to set your phone to vibrate when you receive an incoming call.

Volume – Allows you to set the volume for ringtones, media and alarms. If you deselect the option to use the incoming call volume for notifications, you can set the volume for incoming calls and notifications separately.

< Incoming calls >

Phone ringtone – Allows you to set your default incoming call ringtone.

< Notifications >

Notification ringtone – Allows you to set your default notification ringtone.

< Feedback >

Audible touch tones – Allows you to set the phone to play tones when using the dialpad to dial numbers.

Audible selection – Allows you to set your phone to play a sound when you touch buttons, icons and other onscreen items that react to your touch.

Screen lock sounds – Allows you to set your phone to play a sound when locking and unlocking the screen.

Haptic feedback – Allows your phone to vibrate when pressing soft keys and on certain UI interactions.

Display

Brightness – Adjust the screen brightness.

Auto-rotate screen – Set to switch orientation automatically when you rotate the phone.

Animation – Set to display an animation.

Settings

Screen timeout – Set the time for screen timeout.

Location & security

Use wireless networks – If you select **Use wireless networks**, your phone determines your approximate location using Wi-Fi and mobile networks. When you select this option, you're asked whether you consent to allowing Google to use your location when providing these services.

Use GPS satellites – If you select **Use GPS satellites**, your phone determines your

location to street level accuracy.

Set up screen lock – Set an unlock pattern to secure your phone. Opens a set of screens that guide you through drawing a screen unlock pattern. You can set a **PIN** or **Password** instead of a **Pattern** or leave it as **None**.

When you turn on your phone or wake up the screen, you're asked to draw your unlock pattern to unlock the screen.

Set up SIM/RUIM card lock – Set up SIM/RUIM card lock or change the SIM/RUIM PIN.

Visible passwords – Select to show passwords as you type them or deselect to hide passwords as you type them.

Select device administrators – Add one or more administrators.

Use secure credentials – Allows you to access secure certificates.

Install from SD card – Choose to install encrypted certificates from your SD card.

Set password – Set or change the credential storage password.

Clear storage – Clear credentials for all content and reset password.

Applications

You can manage applications and set up quick launch shortcuts.

Unknown sources – Default setting to install non-Market applications.

Manage applications – Manage and remove installed applications.

Running services – Check services that are currently running.

Storage use – View storage used by applications.

Settings

Battery use – See what has been using the battery.

Development – Set options for application development.

Accounts & sync

< General sync settings >

Background data – Permits applications to synchronise data in the background, whether or not you are actively working in them. Deselecting this setting can save battery power and lowers (but does not eliminate) data usage.

Auto-sync – Permits applications to synchronise, send and receive data to their own schedule.

< Manage accounts >

List of all Google accounts and other accounts you've added to your phone.

If you touch an account in this screen, its account screen opens.

Privacy

If you select Factory data reset, it will erase all of your personal data from the internal phone storage, including information about

your Google account, any other accounts, your system/application data and settings as well as any downloaded applications and DRM licence.

Resetting the phone does not erase any system software updates you have downloaded or any files on your microSD card, such as music or photos. If you reset the phone in this way, you are prompted to re-enter the same information that you did when you first started Android.

SD card & phone storage

< USB connection mode >

Mass storage only – Your phone can be used as a mass storage device if you have a memory card inserted. You can set **Mass storage only** as a default setting of the USB connection mode.

< SD card >

Check total available SD card space. Touch **Unmount SD card** for safe removal. **Format SD card** if you want to delete all data from the SD card.

Settings

< Internal phone storage >

Checks the available space.

Language & keyboard

Set local language and region as well as keyboard settings.

Voice input & output

< Voice input >

Voice recogniser settings – Use the **Voice recogniser settings** to configure the Android voice input feature.

- **Language:** Opens a screen where you can set the language you use for speech to enter text.
- **SafeSearch:** Opens a dialog where you can set whether you want the Google SafeSearch filter to block some results.
- **Block offensive words:** When deselected, Google voice recognition will recognise and transcribe words many people consider offensive, when you use speech to enter text. When selected, Google voice recognition replaces those words in transcriptions with a placeholder comprised of hash symbols (#).

< Voice output >

Text-to-speech settings – Use the **Text-to-speech settings** to configure the Android text-to-speech synthesiser for applications that can use this feature.

NOTE: if you don't have speech synthesiser data installed, only the **Install voice data setting** is available.

- **Listen to an example:** Plays a brief sample of the speech synthesiser, using your current settings.

- **Always use my settings:** Tick to use the settings on this screen in place of speech synthesiser settings available in other applications.
- **Default Engine:** Opens a dialog where you can set the text-to-speech application you want to use, if you have more than one installed.
- **Install voice data:** If your phone does not have speech synthesiser data installed, this connects to Android Market and guides you through the process of downloading and installing the data.

Settings

This setting is not available if the data is already installed.

- **Speech rate:** Opens a dialog where you can select how quickly you want the synthesiser to speak.
- **Language:** Opens a dialog where you can select the language of the text you want the synthesiser to read. This is particularly useful in combination with **Always use my settings** to ensure that text is spoken correctly in a variety of applications.
- **Pico TTS:** Configure the **Pico TTS settings**.

Accessibility

Use the **Accessibility** settings to configure accessibility plug-ins you have installed on your phone.

NOTE: requires additional plug-ins.

Date & time

Use **Date & time** settings to set your preference for how dates are displayed. You can also use these settings to set your own time and time zone rather than obtaining the current time from the mobile network.

About phone

View legal information and check phone status and software version.

Software update

Phone software update

LG Mobile phone software update from the Internet

For more information about using this function, please visit the <http://update.lgmobile.com> or <http://www.lg.com/common/index.jsp> → select country and language.

This feature allows you to update the firmware on your phone to a newer version conveniently from the Internet without needing to visit a service centre. This feature is only available if and when LG makes the

newer version of the firmware available for your device.

As the mobile phone firmware update requires the user's full attention for the duration of the update process, please make sure you check all instructions and notes that appear at each step before proceeding. Please note that removing the USB data cable or battery during the upgrade may seriously damage your mobile phone.

NOTE: LG reserves the right to make firmware updates available only for selected models at its own discretion and does

not guarantee the availability of the newer version of the firmware for all handset models.

LG Mobile Phone software update via Over-the-Air (OTA)

This feature allows you to update the firmware of your phone to the newer version conveniently via OTA without connecting the USB data cable. This feature is only available if and when LG makes the newer version of the firmware available for your device.

First, you can check the software version on your mobile phone: **Settings > About**

phone > Software update > Check now for update.

You can also delay the update by 1 hour, 4 hours, 8 hours or 24 hours. In this case, the application will notify you to update when the time is up. You can also rearrange an update manually.

NOTE: This feature is dependent on the network service provider, region or countries.

Software update

DivX Mobile **DivX**

ABOUT DIVX VIDEO: DivX® is a digital video format created by DivX, LLC, a subsidiary of Rovi Corporation. This is an official DivX Certified® device that plays DivX video. Visit divx.com for more information and software tools to convert your files into DivX videos.

ABOUT DIVX VIDEO-ON-DEMAND: This DivX Certified® device must be registered in order to play purchased DivX Video-on-Demand (VOD) movies. To obtain your registration code, locate the DivX VOD section in your device setup menu. Go to

vod.divx.com for more information on how to complete your registration.

DivX Certified® to play DivX® video up to 320x240.

DivX®, DivX Certified® and associated logos are trademarks of Rovi Corporation or its subsidiaries and are used under licence.

Notice:

Open Source Software

To obtain the corresponding source code under GPL, LGPL, MPL and other open source licences, please visit <http://opensource.lge.com/>

All referred licence terms, disclaimers and notices are available for download with the source code.

Accessories

These accessories are available for use with the LG-E510. (Items described below may be optional.)

Travel adapter



Battery



Stereo headset



Data cable

Connect your LG-E510 and PC.



User Guide

Learn more about your LG-E510.



NOTE:

- Always use genuine LG accessories.
- Failure to do this may void your warranty.
- Accessories may vary in different regions..

Technical data

Ambient temperatures

Max: +55°C (discharging),
+45°C (charging)

Min: -10°C

Declaration of Conformity



Supplier Details

Name

LG Electronics Inc

Address

: LG Twin Tower 20, Yeouido-dong, Yeongdeungpo-gu Seoul, Korea 150-721

Product Details

Product Name

GSM 850 / E-GSM 900 / DCS 1800 / PCS 1900 Quad Band and WCDMA Terminal Equipment

Model Name

LG-E510

Trade Name

LG

CE0168

Applicable Standards Details

RATTE Directive 1999/5/EC

EN 301 489-01 V1.2.1 / EN 301 489-07 V1.3.1 / EN 301 488-17 V2.1.1 /

EN 301 489-10 V1.2.1 / EN 301 489-24 V1.5.1

EN 300 328 V1.7.1

EN 60950-1:2006+A11:2009

EN 50393:2001 / AC:2006 / EN62209-1:2006 / EN62209-2:2010

EN 301 511 V9.0.2

EN 301 908-1 V4.2.1 / EN 301 908-2 V4.2.1

Supplementary Information

The conformity to above standards is verified by the following Notified Body(BABT)

BABT, Forsyth House, Churchfield Road, Watlington-Thames, Surrey, KT12 2TD, United Kingdom

Notified Body Identification Number : 0168

Declaration

I hereby declare under our sole responsibility that the product mentioned above to which this declaration refers complies with the above mentioned standards, regulation and directives

Name

Doo Haeng Lee / Director

Issued Date

5, September 2011

LG Electronics Inc. – EU Representative
Veluwezoom 15, 1327 AE Almere, The Netherlands

Signature of representative

Troubleshooting

This chapter lists some problems you might encounter while using your phone. Some problems require you to call your service provider, but most are easy to fix yourself.

Message	Possible causes	Possible corrective measures
SIM error	There is no SIM card in the phone or it is inserted incorrectly.	Make sure that the SIM card is correctly inserted.
No network connection/ Losing network	Signal is weak or you're outside the carrier network. Operator applied new services.	Move towards a window or into an open area. Check the network operator coverage map. Check whether the SIM card is more than 6~12 months old. If so, change your SIM at your network provider's nearest branch. Contact your service provider.

Message	Possible causes	Possible corrective measures
Codes do not match	To change a security code, you will need to confirm the new code by re-entering it. The two codes you have entered do not match.	The default code is [0000]. If you forget the code, contact your service provider.
Any application cannot be set	Not supported by service provider or registration required.	Contact your service provider.
Calls not available	Dialling error New SIM card inserted. Pre-paid charge limit reached.	New network not authorised. Check for new restrictions. Contact service provider or reset limit with PIN2.

Troubleshooting

Message	Possible causes	Possible corrective measures
Phone cannot be switched on	On/Off key pressed too briefly. Battery is not charged. Battery contacts are dirty.	Press the On/Off key down for at least two seconds. Charge battery. Check charging indicator on the display. Clean the battery contacts.

Message	Possible causes	Possible corrective measures
Charging error	<p>Battery is not charged.</p> <p>Outside temperature is too hot or cold.</p> <p>Contact problem</p> <p>No voltage</p> <p>Charger defective</p> <p>Wrong charger</p> <p>Battery defective</p>	<p>Charge battery.</p> <p>Make sure phone is charging at a normal temperature.</p> <p>Check the charger and connection to the phone. Check the battery contacts and clean them if necessary.</p> <p>Plug the charger into a different socket.</p> <p>If the charger does not warm up, replace it.</p> <p>Only use original LG accessories.</p> <p>Replace battery.</p>
Number not permitted	The Fixed dialling number function is on.	Check the Settings menu and turn the function off.

Troubleshooting

Message	Possible causes	Possible corrective measures
Impossible to receive / send SMS & picture	Memory full	Delete some messages from the phone.
Files not opening	Unsupported file format	Check the file formats that can be supported.
SD card not working	FAT16, FAT32 file system supported	Check SD card file system via card reader, or format SD card using the phone.
The screen does not turn on when I receive a call.	Proximity sensor problem	If you use any protection tape or case, check to see if it has covered the area around the proximity sensor. Make sure that the area around the proximity sensor is clean.

Message	Possible causes	Possible corrective measures
No sound	Vibration mode	Check the settings status of the sound menu to make sure you are not in vibrate or silent mode.
Hang up or freeze	Intermittent software problem	Remove the battery, insert it again and switch on the phone. Try to perform a software update via the website.
Phone locked and does not function.	Restarting the phone	<ol style="list-style-type: none"> 1. Turn the phone off. 2. Remove the back cover. 3. Remove the battery and reinstall it. 4. Close the back cover. 5. Turn the phone on again.

