

HELLOMOTO

Technology promised to make things easier... but then it gave you more to do—phone calls, e-mails, music, photos, videos, the Internet, and more. **It's time to take back control.** It's time to meet the MOTO Q™ 9h.

My Phone, My Way Use photos for your wallpaper, use your songs for your ringtones, use new programs that you load onto your phone... you get the idea.

Anytime Entertainment Load video and music files to make a media library that goes anywhere.

Working Remotely Check e-mail and edit Microsoft® Office documents anywhere in the world.

Help & QuickStart Tour On-phone help is available anytime. Just press **Start > Help and QuickStart.**

For more: www.motorola.com/support/9h

1

Introducing your new **MOTO Q™ 9h** wireless phone! Here's a quick anatomy lesson.

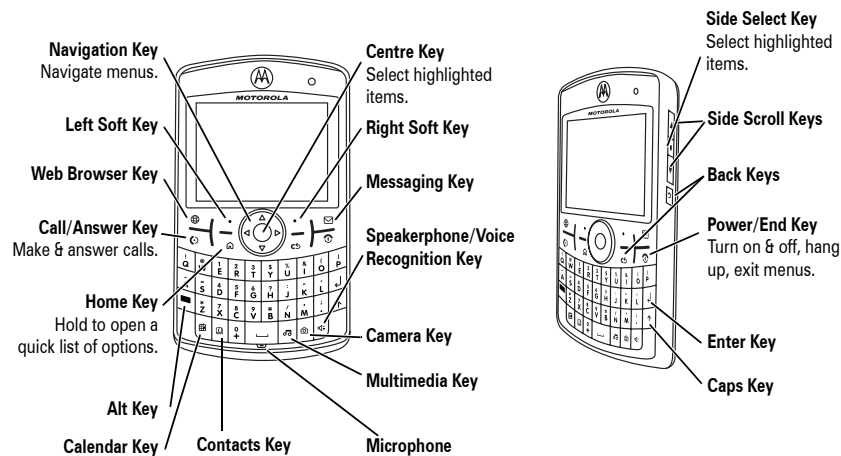

2

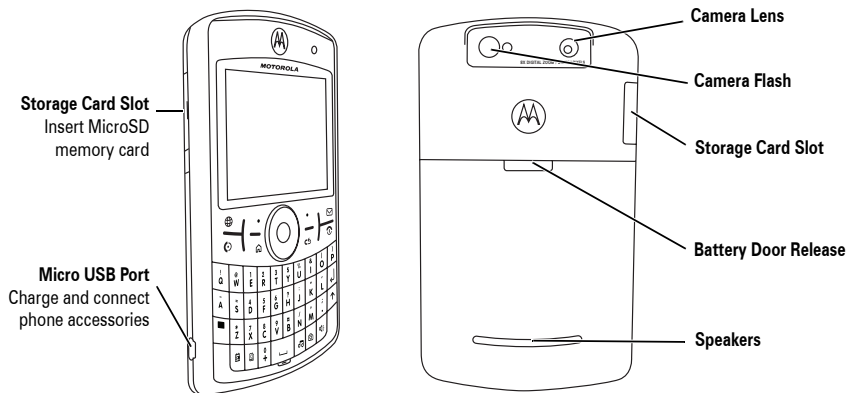

Warning: To avoid damaging your phone, carry it in an approved holster or case rather than a pocket, purse or bag.

3

From the home screen, press **Start** to open the main menu.

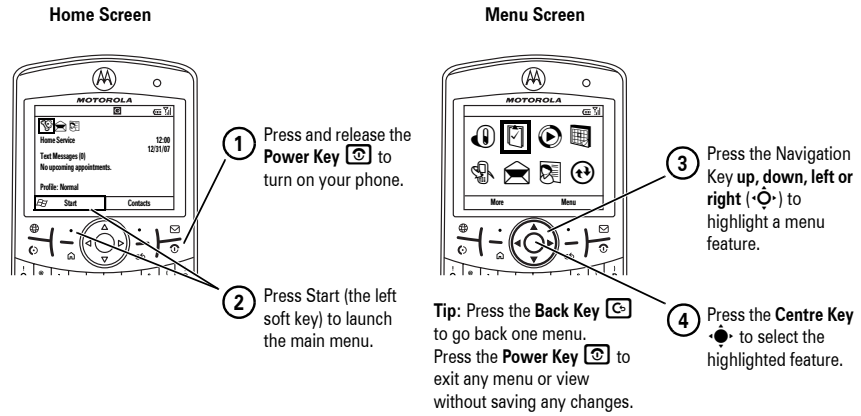

If you need help while using your phone, see the Motorola Support Web site at www.motorola.com/support/9h

Certain mobile phone features are dependent on the capabilities and settings of your service provider's network. Additionally, certain features may not be activated by your service provider, and/or the provider's network settings may limit the feature's functionality. Always contact your service provider about feature availability and functionality. All features, functionality, and other product specifications, as well as the information contained in this user's guide are based upon the latest available information and are believed to be accurate at the time of printing. Motorola reserves the right to change or modify any information or specifications without notice or obligation.

MOTOROLA and the Stylized M Logo are registered in the US Patent & Trademark Office. All other product or service names are the property of their respective owners. The Bluetooth trademarks are owned by their proprietor and used by Motorola, Inc. under license. Java and all other Java-based marks are trademarks or registered trademarks of Sun Microsystems, Inc. in the U.S. and other countries. Microsoft, Windows and Windows Me are registered trademarks of Microsoft Corporation; and Windows XP is a trademark of Microsoft Corporation.

© Motorola, Inc., 2007.

Caution: Changes or modifications made in the radio phone, not expressly approved by Motorola, will void the user's authority to operate the equipment.

Software Copyright Notice

The Motorola products described in this manual may include copyrighted Motorola and third-party software stored in semiconductor memories or other media. Laws in the United States and other countries preserve for Motorola and third-party software providers certain exclusive rights for copyrighted software, such as the exclusive rights to distribute or reproduce the copyrighted software. Accordingly, any copyrighted software contained in the Motorola products may not be modified, reverse-engineered, distributed or reproduced in any manner to the extent allowed by law. Furthermore, the purchase of the Motorola products shall not be deemed to grant either directly or by implication, estoppel or otherwise, any license under the copyrights, patents or patent applications of Motorola or any third-party software provider, except for the normal, non-exclusive, royalty-free license to use that arises by operation of law in the sale of a product.

contents









start menu	8	tips & tricks	28
safety information	9	basics	29
FCC Notice	16	display	29
use and care	18	text entry	32
EU Conformance	19	volume	34
recycling information	20	handsfree speaker	34
essentials	21	lock & unlock phone	35
about this guide	21	customise	37
SIM card	22	profiles	37
battery	23	time & date	38
turn it on & off	25	home screen	39
make a call	25	backlight	40
answer a call	26	answer options	40
store a phone number	26	third-party applications	40
call a stored number	27	task manager	41
your phone number	27		

calls	42	other features	78
turn off a call alert	42	advanced calling	78
recent calls	42	contacts	79
redial	43	personalising	81
view missed calls	43	call times	83
caller ID	44	handsfree	84
emergency calls	44	network connections	84
international calls	44	calendar	85
speed dial	45	calculator	86
voicemail	46	security	87
three-way calling	46	phone information	87
e-mail & messages	48	fun & games	87
instant messaging	57	Support & service	89
connections	59	SAR Data	90
Bluetooth™ wireless	59	WHO Information	92
synchronise	63	Microsoft License	93
modem-link	67	index	98
web browser	71		
entertainment	72		
take & send a photo	72		
record & play video clip	74		

start menu

main menu

To open the menu from the home screen, press **Start** (the left soft key).

-  **Web Browser**
-  **Tasks**
-  **Windows Media**
-  **Calendar**
-  **Call History**
-  **Messaging**
 - text messages
 - E-mail
 - MMS
-  **Contacts**
-  **ActiveSync**

This is the standard menu layout.





Your phone's menu may be different.

To select menu items, press your navigation key up, down, left or right.

Settings

- Phone
- Sounds
- Profiles
- Text Input Settings
- Home Screen
- Clock Alarm
- Connections
- Security
- Remove Programs
- Power Management
- Accessibility
- Phone Accessibility
- Regional Settings
- Owner Information
- About
- Phone Information
- Packet Data

Games

-  **Voice Notes**
-  **Pictures & Videos**
-  **Accessories**
-  **File Manager**

-  **Games and Apps**
-  **Marketplace**
-  **McAfee VirusScan**
-  **Media Centre**
-  **Virtual Private Networking**
-  **Speed Dial**
-  **Voice Recognition**
-  **Windows Live**
-  **Windows Live Messenger**
-  **Bluetooth™**
-  **System Tools**
-  **Documents To Go**

Safety and General Information

This section contains important information on the safe and efficient operation of your mobile device. Read this information before using your mobile device.¹

Exposure to Radio Frequency (RF) Energy

Your mobile device contains a transmitter and receiver. When it is ON, it receives and transmits RF energy. When you communicate with your mobile device, the system handling your call controls the power level at which your mobile device transmits.

1. The information provided in this document supersedes the general safety information in user's guides published prior to May 1, 2006.

Follow Instructions to Avoid Interference Problems

Turn off your mobile device in any location where posted notices instruct you to do so. These locations include hospitals or health care facilities that may be using equipment that is sensitive to external RF energy.

In an aircraft, turn off your mobile device whenever instructed to do so by airline staff. If your mobile device offers an airplane mode or similar feature, consult airline staff about using it in flight.

Pacemakers

If you have a pacemaker, consult your doctor before using this device.

Persons with pacemakers should observe the following precautions:

- ALWAYS keep the mobile device more than 20 centimetres (8 inches) from your pacemaker when the mobile device is turned ON.

Your Motorola mobile device is designed to comply with local regulatory requirements in your country concerning exposure of human beings to RF energy.

Operational Precautions

For optimal mobile device performance and to be sure that human exposure to RF energy does not exceed the guidelines set forth in the relevant standards, always follow these instructions and precautions.

External Antenna Care

If your mobile device has an external antenna, use only a Motorola-supplied or approved replacement antenna. Use of unauthorised antennas, modifications or attachments could damage the mobile device and/or may result in your device not complying with local regulatory requirements in your country.

DO NOT hold the external antenna when the mobile device is IN USE. Holding the external antenna affects call quality and may cause the mobile device to operate at a higher power level than needed.

Product Operation

When placing or receiving a phone call, hold your mobile device just like you would a landline phone.

If you wear the mobile device on your body, always place the mobile device in a Motorola-supplied or approved clip, holder, holster, case or body harness. If you do not use a body-worn accessory supplied or approved by Motorola, keep the mobile device and its antenna at least 2.5 centimetres (1 inch) from your body when transmitting.

When using any data feature of the mobile device, with or without an accessory cable, position the mobile device and its antenna at least 2.5 centimetres (1 inch) from your body.

Using accessories not supplied or approved by Motorola may cause your mobile device to exceed RF energy exposure guidelines. For a list of Motorola-supplied or approved accessories, visit our Web site at: www.motorola.com.

RF Energy Interference/Compatibility

Nearly every electronic device is subject to RF energy interference from external sources if inadequately shielded, designed or otherwise configured for RF energy compatibility. In some circumstances your mobile device may cause interference with other devices.

- DO NOT carry the mobile device in the breast pocket.
- Use the ear opposite the pacemaker to minimise the potential for interference.
- Turn OFF the mobile device immediately if you have any reason to suspect that interference is taking place.

Hearing Aids

Some mobile devices may interfere with some hearing aids. In the event of such interference, you may want to consult your hearing aid manufacturer or doctor to discuss alternatives.

Other Medical Devices

If you use any other personal medical device, consult your doctor or the manufacturer of your device to determine if it is adequately shielded from RF energy.



Driving Precautions

Check the laws and regulations on the use of mobile devices in the area where you drive. Always obey them.

When using your mobile device while driving, please:

- Give full attention to driving and to the road. Using a mobile device may be distracting. Discontinue a call if you cannot concentrate on driving.
- Use handsfree operation, if available.
- Pull off the road and park before making or answering a call if driving conditions so require.

Responsible driving practices can be found in the “Smart Practices While Driving” section at the end of this guide and/or at the Motorola Web site: www.motorola.com/callsmart.

Symbol	Definition
	Do not let your battery, charger or mobile device get wet.
	Listening at full volume to music or voice through a headset may damage your hearing.

Choking Hazards

Your mobile device or its accessories may include detachable parts, which may present a choking hazard to small children. Keep your mobile device and its accessories away from small children.

Operational Warnings

Obey all posted signs when using mobile devices in public areas, such as health care facilities or blasting areas.

Automobile Air Bags

Do not place a mobile device in the air bag deployment area.

Potentially Explosive Atmospheres

Areas with potentially explosive atmospheres are often but not always posted and can include fuelling areas such as below decks on boats, fuel or chemical transfer or storage facilities or areas where the air contains chemicals or particles, such as grain, dust or metal powders.

When you are in such an area, turn off your mobile device and do not remove, install or charge batteries. In such areas, sparks can occur and cause an explosion or fire.

Glass Parts

Some parts of your mobile device may be made of glass. This glass could break if the product is dropped on a hard surface or receives a substantial impact. If glass breaks, do not touch or attempt to remove. Stop using your mobile device until the glass is replaced by a qualified service centre.

Seizures/Blackouts

Some people may be susceptible to epileptic seizures or blackouts when exposed to flashing lights, such as when playing video games. These may occur even if a person has never had a previous seizure or blackout.

If you have experienced seizures or blackouts or if you have a family history of such occurrences, please consult with your doctor before playing video games or enabling a flashing-lights feature (if available) on your mobile device.

Damaged Products

If your mobile device or battery has been submerged in water, punctured or subjected to a severe fall, do not use it until you take it to a Motorola Authorised Service Centre. Do not attempt to dry it with an external heat source, such as a microwave oven.

Batteries and Chargers

If jewellery, keys, beaded chains or other conductive materials touch exposed battery terminals, this could complete an electrical circuit (short circuit), become very hot and could cause damage or injury. Be careful when handling a charged battery, particularly when placing it inside a pocket, purse or other container with metal objects. **Use only Motorola Original batteries and chargers.**



Caution: To avoid risk of personal injury, do not dispose of your battery in a fire.





Discontinue use and consult a doctor if any of the following symptoms occur: convulsion, eye or muscle twitching, loss of awareness, involuntary movements or disorientation. It is always a good idea to hold the screen away from your eyes, leave the lights on in the room, take a 15-minute break every hour and stop use if you are very tired.

Caution About High Volume Usage



Listening at full volume to music or voice through a headset may damage your hearing.

Your battery, charger or mobile device may contain symbols, defined as follows:

Symbol	Definition
	Important safety information follows.
	Do not dispose of your battery or mobile device in a fire.
	Your battery or mobile device may require recycling in accordance with local laws. Contact your local regulatory authorities for more information.
	Do not throw your battery or mobile device in the trash.
	Your mobile device contains an internal lithium ion battery.

Repetitive Motion

When you repetitively perform actions such as pressing keys or entering finger-written characters, you may experience occasional discomfort in your hands, arms, shoulders, neck or other parts of your body. If you continue to have discomfort during or after such use, stop use and see a doctor.

FCC Notice To Users

The following statement applies to all products that have received FCC approval. Applicable products bear the FCC logo, and/or an FCC ID in the format FCC-ID:xxxxxx on the product label.

Motorola has not approved any changes or modifications to this device by the user. Any changes or modifications could void the user's authority to operate the equipment. See 47 CFR Sec. 15.21.

This device complies with part 15 of the FCC Rules. Operation is subject to the following two conditions: (1) This device may not cause harmful interference, and (2) this device must accept any interference received, including interference that may cause undesired operation. See 47 CFR Sec. 15.19(3).

If your mobile device or accessory has a USB connector, or is otherwise considered a computer peripheral device whereby it can be connected to a computer for purposes of transferring data, then it is considered a Class B device and the following statement applies:

This equipment has been tested and found to comply with the limits for a Class B digital device, pursuant to part 15 of the FCC Rules. These limits are designed to provide reasonable protection against harmful interference in a residential installation. This equipment generates, uses and can radiate radio frequency energy and, if not installed and used in accordance with the instructions, may cause harmful interference to radio communications. However, there is no guarantee that interference will not occur in a particular installation. If this equipment does

cause harmful interference to radio or television reception, which can be determined by turning the equipment off and on, the user is encouraged to try to correct the interference by one or more of the following measures:

- Reorient or relocate the receiving antenna.
- Increase the separation between the equipment and the receiver.
- Connect the equipment to an outlet on a circuit different from that to which the receiver is connected.
- Consult the dealer or an experienced radio/TV technician for help.

Use and Care

To care for your Motorola phone, please keep it away from:



liquids of any kind

Don't expose your phone to water, rain, extreme humidity, sweat, or other moisture.



extreme heat or cold

Avoid temperatures below -10°C/14°F or above 45°C/113°F.



microwaves

Don't try to dry your phone in a microwave oven.



dust and dirt

Don't expose your phone to dust, dirt, sand, food, or other inappropriate materials.



cleaning solutions

To clean your phone, use only a dry soft cloth. Do not use alcohol or other cleaning solutions.



the ground

Don't drop your phone.

European Union Directives Conformance Statement

CE Hereby, Motorola declares that this product is in compliance with:

- The essential requirements and other relevant provisions of Directive 1999/5/EC
- All other relevant EU Directives

The above gives an example of a typical Product Approval Number.

You can view your product's Declaration of Conformity (DoC) to Directive 1999/5/EC (to R&TTE Directive) at www.motorola.com/rtte. To find your DoC, enter the product Approval Number from your product's label in the "Search" bar on the Web site.

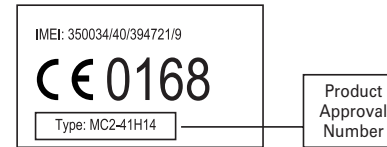

Caring for the Environment by Recycling



This symbol on a Motorola product means the product should not be disposed of with household waste.

Recycling Mobile Phones and Accessories

Please do not dispose of mobile telephones or electrical accessories, such as chargers or headsets, with your household waste. In some countries or regions, collection systems have been set up to handle waste electrical and electronic items. Please contact your regional authorities for more details. If no suitable scheme exists, you may return unwanted mobile telephones and electrical accessories to any Motorola Approved Service Centre in your region.

about this guide

Press the left and right *soft keys* to open menus and select options. Use the *navigation key* to scroll to items and press the *centre key* to select them.

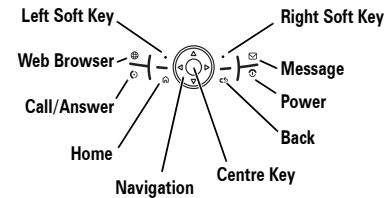

This guide shows how to locate a menu feature as follows:

Find it: Press **Start** > **Call History** > *(received call)*

This means that, from the home screen:

- 1 Press the **left soft key** to open the **Start** menu.
- 2 Press the *navigation key* to scroll to **Call History**. Press the *centre key* to select **Call History**.
- 3 Press the navigation key to scroll to a received call. Press the centre key to select the call.

Tip: You can press the *side scroll keys* to scroll up and down and press the *side select key* to select items (see page 2 for side key locations).

symbols	
	This means a feature depends on the network, SIM card or subscription and may not be available in all areas. Contact your service provider for more information.
	This means a feature requires an optional accessory.

SIM card

Caution: Do not bend or scratch your SIM card. Keep it away from static electricity, water and dirt.

Your *Subscriber Identity Module* (SIM) card contains personal information like your phone number and contacts entries. It can also contain your voicemail, text message

and Internet access settings. If you put your SIM card in another phone, that phone uses your phone number.

To insert and use a **storage card**, see your *Quick Start Guide*.

Turn off your phone and remove your battery before you install or remove a SIM card.

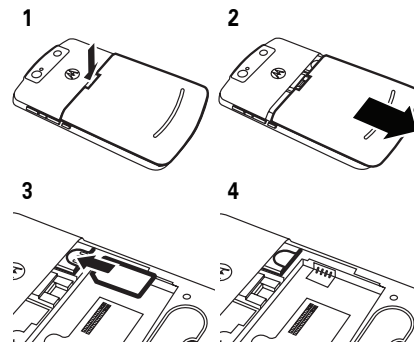

battery

battery installation

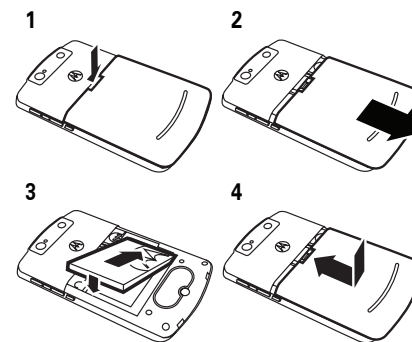

battery charging

New batteries are not fully charged. Plug the battery charger into your phone and an electrical outlet.

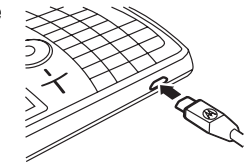

Your phone might take several seconds to start charging the battery. When finished, your display shows a full battery icon.

Tip: Relax, you cannot overcharge your battery. It will perform best after you fully charge and discharge it a few times.

You can also charge your battery with a **USB cable** plugged into a computer, unless your battery is completely drained. Use a wall charger or car charger for completely drained batteries. Install the software from your Getting Started disc onto your PC before you try to charge your phone

through USB port. Plug the cable into a powered USB hub or port, since some USB devices (such as keyboards) might not supply enough power for charging.

conserve battery life

To set how long your phone waits before the **backlight** turns off, press **Start > Settings > Power Management > Backlight time out on battery** or **Backlight time out on AC**. When the backlight is off, the display is visible but dim.

To close unused programs, from the home screen, press **Start > System Tools > Task Manager**. Select the program and press **Menu > Kill**.

battery tips

Battery life depends on the network, signal strength, temperature, features and accessories you use.

- Always use Motorola Original batteries and chargers. The warranty does not cover damage caused by non-Motorola batteries and/or chargers.
- New batteries or batteries stored for a long time may take more time to charge.
- When charging your battery, keep it near room temperature.
- Never expose batteries to temperatures below -10°C (14°F) or above 45°C (113°F). Always take your phone with you when you leave your vehicle.



When storing your battery, keep it uncharged in a cool, dark, dry place.

- It is normal for batteries to gradually wear down and require longer charging times. If you notice a change in your battery life, it is probably time to purchase a new battery.



Contact your local recycling centre for proper battery disposal.

Warning: Never dispose of batteries in a fire because they may explode.

Before using your phone, read the battery safety information in the “Safety and General Information” section included in this guide.

turn it on & off

To turn on your phone, press and release . If prompted, enter your four-digit unlock code.



Tip: If your phone does not power up, make sure your battery is charged.

To turn off your phone, press and hold for 3 seconds, then release it.

Note: If your phone does not power up normally or appears to freeze for an extended period of time, you may need to perform a hard reset. To perform a hard reset: 1. remove and replace the battery, 2. hold the * and E keys, 3. press and release the power button. Continue to hold the * and E keys for at least 5 seconds after the screen turns on. Resetting your phone will result in the loss of your personalised settings and all content stored in the phone memory.

make a call

From the home screen, enter a phone number and press to make a call.

To voice dial, see page 78.

answer a call

When your phone rings and/or vibrates, press to answer. To “hang up,” press .

- If you are busy when a call comes in, press **Ignore** to send the call directly to voicemail.
- To put a call on hold, press . To return to the call, press again.
- If you are on a call and another call comes in, you can press **Ignore** to send the new call directly to voicemail or press to answer it and put the current call on hold (press to switch between the two calls).

store a phone number

Find it: Press **Start > Contacts** and press **New**

- 1 Choose whether the contact will be stored on your phone (Outlook contact) or your SIM card. Contacts on the SIM card can only include a name and number.
- 2 Enter information for the contact.

Tip: While you are entering the number, you can tell your phone to pause and then dial more digits (such as a voicemail password or PIN). Press **Menu > Insert Pause** to insert a 2-second pause (shows as a p) or press **Menu > Insert Wait** to tell your phone to prompt you before dialing the remaining digits (shows as a w). **Insert Wait** does not work for contacts stored on your SIM card.

Tip: If you get a call or message from someone who is not in your list of contacts, you can create a contact from **Call History** or from the message by pressing **Menu > Save to Contacts**

call a stored number

Find it: Press **Start > Contacts**

- 1 Scroll to the number.
- 2 Press .

Your phone calls the contact’s default number.







Tip: If you stored more than one number for a contact, select the contact to see the other numbers. To dial a number, scroll to it and press .



your phone number

To view your phone number, press **Start > Settings > Phone > Call Options**.

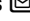
tips & tricks

From the home screen (shown on page 29), you can use the following shortcuts:

How to...
lock phone Press and hold  to open the quick options menu, then select Lock .
open recently used features Icons for your most recently used features appear across the top of the home screen. Use the navigation key to select one.
open your music, messages, and more Use shortcut keys to access your music  , camera  , phonebook  , calendar  , messages  , and Web browser  .

How to...
open quick options Press and hold  .
play music or games on an airplane To keep using your games and music on a flight, turn off your network and Bluetooth™ services. Press and hold  until the quick list appears, then select Wireless Manager > All .

basics

See page 2 for a basic phone diagram.

display

The *home screen* appears when you turn on the phone. To dial a number from the home screen, press number keys and .

Your MOTO Q™ 9h includes intelligent display which automatically adjusts screen brightness based on ambient lighting conditions. To disable this feature **Start** > **Settings** > **Power Management** > **Smart Backlight** > **Disable**

Note: Your home screen may look different, than this one.

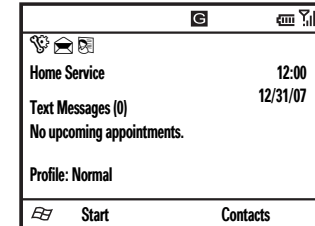

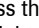
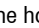

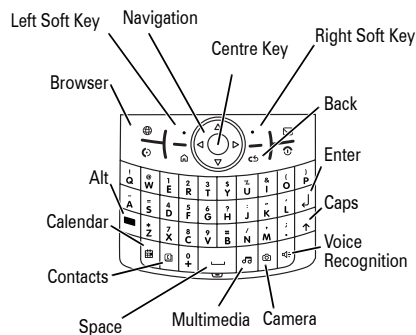



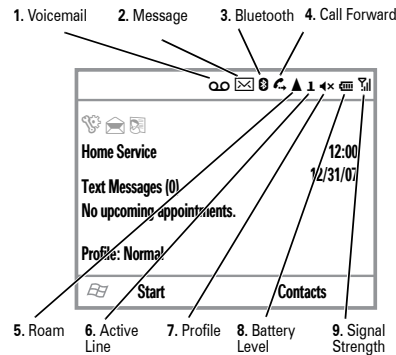

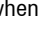
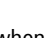

Soft key labels show the current soft key functions. For soft key locations, see page 2. Press the *navigation key*  up, down, left or right to scroll to basic menu items or text in the home screen. Press  to return to the home screen.

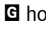
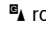

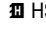
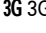
Status indicators can appear at the top of the home screen:

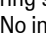
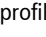

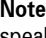
- 1 **Voicemail Indicator** – Shows  when you have new voicemail.
- 2 **Message Indicator** – Shows when you receive new messages. 
- 3 **Bluetooth™ Indicator** – Shows  when you have a Bluetooth wireless connection.
- 4 **Call Forward Indicator** – Shows  when call forwarding is on.
- 5 **Roam Indicator** – Shows  when your phone is seeking or using a network outside your home network. Other indicators can include:
 -  home GPRS
 -  roaming GPRS
 -  EDGE
 -  HSDPA
 -  3G
- 6 **Active Line Indicator** – For multi-line SIM cards, this indicates whether line 1 or 2 is active. 
- 7 **Profile Indicator** – Shows when your ring style is set to **Silent** () or **Vibrate** (). No indicator appears when the ring style profile is **Normal**, **Outdoor** or **Automatic**.

Note: A  appears when the speakerphone is on (see page 34).
- 8 **Battery Level Indicator** – Vertical bars show the battery charge level. Recharge the battery when your phone shows one or two bars.
- 9 **Signal Strength Indicator** – Vertical bars show the strength of the network connection. You can't make or receive calls when no vertical bars appear. Arrow indicators above the signal strength indicator signify data transfer to the phone. 

text entry

You can enter text and numbers using the keypad. When you select a field that requires text or numbers, the phone automatically selects the appropriate entry mode. An indicator at the top right of the display shows the entry mode you are currently using.

Press  to switch entry modes. For indicator descriptions, see the following section.

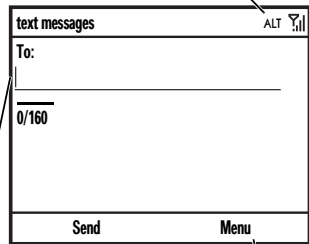

Flashing cursor indicates insertion point.

Press **Menu** to open the sub-menu.

volume

When you are not on a call, hold the side select key to show **master volume**, then press the volume keys to adjust it. Master volume controls all sound except the other caller's voice on phone calls.

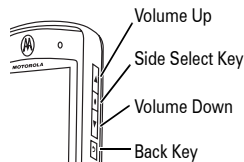

When you are in a phone call, press volume up/down keys to adjust the **other caller's voice volume**.

- Need to change profiles on the fly? On the home screen, scroll to and select **Profile**. Choose from **Normal**, **Silent**, **Meeting** and others.

Press  in a text entry view to select an entry mode:





entry modes	
abc	Enters the large character on each key (such as Q).
ALT	Enters the small symbol or number on the next key pressed (such as !), then returns to the previous text entry mode.
ALT	Enters the small symbols and numbers on the keys until you press  again. Your phone automatically chooses ALT for entries that only allow numbers, like phone numbers.

- Want to turn off a sound? Press **Start** > **Settings** > **Sounds**. Highlight the desired item and select the sound you want to associate with that item.

Tip: You can eliminate the ringer volume instantly when an incoming call comes in - just use the *side scroll keys* to turn the ringer off.

handsfree speaker

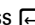

Note: The use of wireless phones while driving may cause distraction. Discontinue a call if you cannot concentrate on driving. Additionally, the use of wireless devices and their accessories may be prohibited or restricted in certain areas. Always obey the laws and regulations on the use of these products.

- To **delete** one character, press . Hold  to keep deleting.

- To start a new line, press .

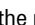

- To enter capital letters, press  to switch to all capital letters (**ABC**), no capitals (**abc**) or next letter capital (**Abc**).

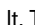



- To enter the number or character above the letter on each key, press the Alt key . Press  twice to lock it. To enter other special characters and foreign alphabet characters, press  followed by the Shift key .

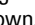

text prediction

As you enter letters, your phone might try to **predict** the word. For instance, it might predict "program" when you enter "prog".

To accept the prediction, press  right. To see alternate predictions, hold  down. To enter a space after your characters (such as "prog"), press . To turn off text prediction, press **Start** > **Settings** > **Text Input Settings** and uncheck **Text Prediction**.

Press   > **Setup** to turn off **text prediction**, change its language or clear its memory of the words you have used.

You can use your phone's handsfree speaker on calls without holding the phone to your ear.

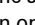
During a call, press  to turn on the handsfree speaker. A  at the top of your display indicates the speaker is on. To turn it off, press  again or end the call.

Note: The handsfree speaker will not work when your phone is connected to a car kit or headset.

lock & unlock phone

You can manually lock your phone to prevent accidental keypresses.

To **lock your phone**, press and hold  until the **Quick List** opens. Then, select **Lock**. Your left soft key becomes **Unlock**.

To **unlock your phone**, press **Unlock** and enter your password. Your phone uses * if you have not set a password.

To **keep others from using your phone**, change your password:

Find it: From the home screen, press **Start** > **Settings** > **Security** > **Device Lock**

- 1 Check the **Prompt if device unused** for checkbox and select the amount of time for the phone to be inactive before automatically locking.
- 2 Choose a password type that is either simple (4-digit number) or strong alphanumeric (a hard-to-guess password with at least 7 characters, including uppercase and lowercase letters, numerals and punctuation).
- 3 Enter and confirm your password.
- 4 Press **Done**.

To unlock the phone, press **Unlock**. When you see the unlock prompt, enter your password and press **Done**.

Tip: Be certain to remember your password. Without your password, you can reset your phone, but it will result in the loss of your personalised settings and all content stored in phone memory. To perform a hard reset, hold down the ***** and **E** keys for 5 seconds while turning the phone on.

Tip: You can make emergency calls on a locked phone (see page 44). A locked phone still rings or vibrates for incoming calls or messages, **but you do not need to unlock it to answer.**

profiles

Each profile uses a different set of sounds, ring styles, earpiece volume settings or vibrations for incoming calls and other events. For example, the **Outdoor** profile volume is much louder than the **Normal** profile.

Here are the profiles you can choose:

Normal	Vibrate	Automatic
Silent	Outdoor	

Indicators can appear at the top of your home screen for the **Silent** (⏏) and **Vibrate** (🔔) profiles. A 📞 means the speakerphone is on (see page 34).

Note: The **Automatic** profile is the same as **Normal**, except that it automatically switches to **Vibrate** during any event stored in your Calendar.

To choose your profile:

Find it: On the home screen, scroll and select **Profile:** > *profile style name*

change ring tones

You can change the ring tones for incoming calls and other events.

Find it: Press **Start** > **Settings** > **Sounds**

Note: Changes made to the alert settings will have no effect when using the **Silent** profile.

- 1 Scroll and highlight the sound you want to change, then press the *navigation key* ⏏ right or left to change it.
- 2 Press the **Done** key to save the sound setting.

Note: If you download a sound file for a ring tone, it does not automatically save in the Sounds location. To move your sound file, press **Start** > **File Manager** > **My Documents**. Highlight the sound file you want to copy to the Sound location, press **Menu** > **File** > **Copy To** and select **Application Data** > **Sounds**. If the sound file is not located in the My Documents folder, go to the folder where the sound file is stored and copy it to the Sounds folder.

time & date

Your service provider usually sets the time and date on your phone. To change it manually:

Find it: Press **Start** > **Settings** > **Clock Alarm** > **Date and Time**

- 1 In **Time zone**, use the *navigation key* ⏏ to select your time zone.
Note: Update your time zone when you travel, to make sure your phone's calendar events appear at the right time.
- 2 In **Date**, edit the month, day or year.
- 3 In **TIME**, edit the hour, minute and second.
- 4 Press **Done** to save the clock and date settings.

You can specify the date and time style by changing the regional settings. Press **Start** > **Settings** > **Regional Settings**.

home screen

Set a photo or picture as a wallpaper (background) image or change your layout and color scheme on your home screen.

Find it: Press **Start** > **Settings** > **Home Screen**

options
Home screen layout Select a layout for the home screen.
Colour Scheme Select a color scheme for the display.
Background image Select a picture for your wallpaper image or Default for default wallpaper.
Time out Select the time interval before the display will return to the home screen or Never .

change background image

Want to copy an image from your PC to your phone to use as a background image?

Note: You must have Microsoft® Exchange ActiveSync on your PC installed as described on page 64.

- 1 Connect the phone to your PC.
- 2 On your PC, copy the image file you want. The file format must be .gif, .jpg or .bmp.
- 3 In ActiveSync on your PC, select Explore and double-click My Windows® Mobile device.
- 4 Double-click Application Data, double-click Home and paste the image into that folder.

Note: If you download a picture file for a wallpaper, it might not automatically save in the **My Pictures** folder. To move your picture file, press **Start > File Manager > My Documents**. Highlight the picture file you want to copy to the My Pictures location, press **Menu > File > Copy To** and select **My Documents > My Pictures**. If the picture file is not located in the **My Documents** folder, go to the folder where the picture file is stored and copy it to the **My Pictures** folder.

backlight

Your phone automatically adjusts the display brightness when you move between bright and dark environments. To save battery life, your display backlight turns off when you're not using your phone. The backlight turns back on when you press a

key. To set how long your phone waits before the backlight turns off:

Find it: Press **Start > Settings > Power Management > Backlight time out on battery** or **Backlight time out on AC**

answer options

To use **any key** to answer an incoming call, press **Start > Settings > Phone > Call Options > Any key answer**.

third-party applications

Third-party applications or add-on programs, can include e-mail, security, mobile office and productivity software.

These products can typically be downloaded and installed immediately. Compatible commercial and free applications are available on the Internet.

For more information, see the downloads catalog on the Motorola Support Web site at: www.motorola.com/support/9h or see your service provider's Web site.

Note: Applications written for previously released devices or older versions of Windows Mobile may not function reliably on this phone. Contact the application provider to check compatibility before installing the application on this phone.

task manager

Want to see what programs are running (active) on your phone? Use the Task Manager to see the programs or stop a specific program from running.

Find it: On the home screen, press **Start > System Tools > Task Manager**

Tip: Need to stop running program? In **Task Manager**, select the program and press **Menu > Kill**.

Note: If you want to completely remove a program from your phone, from the home screen, press **Start > Settings > Remove Programs**.

calls

To make and answer calls, see page 25.



turn off a call alert

You can use the *side scroll keys* to turn off the ringer before answering the call.

recent calls

Your phone keeps a list of incoming and outgoing calls, even for calls that did not connect. The most recent calls are listed first. The oldest calls are deleted as new calls are added.



Find it: Press **Start** > **Call History** Highlight a call, then:



- To call the number, press .
- To see call details (like time and date), press the *centre key* .
- To see **Menu Options**, press **Menu** from the **Call History** view. This menu includes:

options
Find Contact Find this phone number in your Contacts .
Send Text Message Send a text message to this phone number.

options
E-mail Send an e-mail message to this contact.
View Timers View the call times for this call and all calls.
Delete/Delete List Delete this call from the Call History.
Save to Contacts Save this number to a contact.
Filter Filter all calls in the Call History list. For example, if you filter the list for all Missed Calls, only the incoming phone calls that you did not answer will be listed.

redial

- 1 Press  from the home screen to see the calls list.
- 2 Highlight the entry you want to call, then press .

If you hear a **busy signal** and you see  **Call Rejected, User Busy**, press  to redial the number. When the call goes through, your phone rings or vibrates one time, shows **Redial Successful** and connects the call.

view missed calls

Your phone keeps a record of your unanswered calls.

- 1 Press **Start** > **Call History**.
- 2 Press **Menu** > **Filter** > **Missed Calls**.

caller ID

Calling line identification (caller ID) shows the phone number for an incoming call on your home screen. 

Your phone shows the caller's name and picture when they're stored in your contacts or **Incoming Call** when caller ID information is not available.

You can set your phone to play a distinctive ringer ID for specific entries stored in your contacts (see page 79).

emergency calls

Your service provider programs one or more emergency phone numbers, such as 999, that you can call under any circumstances, even when your phone and keypad are locked.

Note: Emergency numbers vary by country. Your phone's preprogrammed emergency number(s) may not work in all locations and sometimes an emergency call cannot be placed due to network, environmental or interference issues.

- 1 Press the keypad keys to dial the emergency number.
- 2 Press  to call the emergency number.

international calls

If your phone service includes international dialing, press and hold  to insert your local international access code (indicated by +). Then, press the keypad keys to dial the country code and phone number.

speed dial

You can use speed dialing in two ways: quick access for up to 99 phone numbers and shortcuts to features found in the Start menu including e-mail, calendar and Bluetooth™ Manager.

To access speed dial entries, press and hold the single-digit speed dial number for one second. If the speed dial is two digits, press the first digit, then press and hold the second digit. The phone dials the phone number, opens a new e-mail message or goes to the Web page.

phone numbers

You can set the speed dial to call the entries in your phone's contact list:

- 1 Press **Start** > **Contacts**.
- 2 Scroll to the desired contact and press the *centre key* .

- 3 Select the phone number or e-mail address for which to create the speed dial.
- 4 Press **Menu** > **Add to Speed Dial**.
- 5 In the **Keypad assignment**, select the speed dial number to use.
Note: Speed dial 1 is reserved for calling your voicemail.
- 6 Press **Done**.

To **delete** a speed dial entry, press **Start** > **Speed Dial**, scroll to the entry, then press **Menu** > **Delete**.

menu shortcuts

You can set a shortcut to open an application on your phone:

- 1 Press **Start**.

- 2 Scroll to the icon of the application you want a shortcut for and press **Menu** > **Add to Speed Dial**.
- 3 In the **Keypad assignment**, select the speed dial shortcut to use.
- 4 Press **Done**.

Note: To delete a shortcut, press **Start** > **Speed Dial**, scroll to the shortcut, then press > **Menu** > **Delete**. Your service provider might add a **Voicemail** shortcut you cannot delete.

voicemail

Note: Your service provider may include additional information about using this feature.

Your network stores the voicemail messages you receive.



When you **receive** a voicemail message, your phone shows the voicemail message indicator

To **check** voicemail messages:

Press and hold

Note: You cannot store a pause (p) or wait (w) character in your voicemail number. If you want to store a voicemail number with these characters, create a contact for your voicemail number (see page 26) and use the contact to call your voicemail.

three-way calling

While connected to a call:



- 1 Place your current call on hold by pressing
- 2 Enter the number of the other person you wish to connect to a three-way call and press

- 3 Once you are connected to the other phone, you can press **Swap** to switch between the calls or press **Menu** > **Conference** to combine them.

If you **receive a second call** while you are already on a call:

- To answer the second call and put the first call on hold, press **Answer**. Then, you can press **Swap** to switch between the calls or press **Menu** > **Conference** to combine them.
- To send the second call to your voicemail, press **Ignore**.

e-mail & messages



To set up e-mail on your MOTO Q™ 9h, refer to your *Quick Start Guide*. If you have problems setting up email or synchronizing, please visit www.motorola.com/support/9h

receive & read messages

When you receive a message your phone plays an alert and shows **New Message** with a message indicator such as .

Find it: On the home screen, press **Start** > **Messaging** > (*e-mail account*).

If you do not see a list of messages, press **Menu** > **Folders** > **Inbox**. To return to the folder list, press **Menu** > **Folders**.

To read a message: Press the *navigation key*  to scroll to the message and press the *centre key*  to open it.

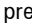
When you have a message open, you can press the *navigation key*  right to open the next message or left to open the previous message.

message attachments

If an e-mail has Microsoft® Word, Excel, or PowerPoint files attached, you can open and edit them using **Documents To Go**. You can also view .pdf file attachments, or extract .zip file attachments.

Download the attachment, then select the file and follow the prompts to open it. When the document opens, you can move around the page using the navigation key .

receives your messages. To stop this process, press **Menu** > **Stop Send/Receive**.

send a message

You can send three types of messages: SMS (text messages), MMS (multimedia messages) and email messages.

Find it: Press **Start** > **Messaging** > **text messages**, **MMS** or (*e-mail account*)

To send a message:

- 1 Press **New**.
- 2 For e-mail, in **To**, **Cc** and/or **Bcc**, enter e-mail addresses. Insert a semicolon (;) between multiple numbers or addresses.

For text messages, enter the contact telephone number or e-mail address.

Tip: You can quickly enter phone numbers or e-mail addresses from your

contact cards. In **To**, press  and select a recipient from the list. Then select the recipient's phone number or e-mail address.

3 Use the keypad to compose a message.

4 Press **Send**.

Tip: In an e-mail or MMS message, you can insert a **picture**, **voice note** or **file** in the message, on the message area press **Menu** > **Insert** > **Picture** or **Voice Note** or **File**.

Note: If you select to insert a voice note into the message, you will also need to record it. Press **Record** and start speaking into the phone's microphone. When finished speaking, press **Stop** and then **Done**.

To set the priority for an e-mail message, press **Menu** > **Message Options**.

To cancel a message, press **Menu** > **Cancel Message**.

- Excel spreadsheets: Select cells and enter numbers or text. Press **Menu** for options like save, cut, copy, paste, find, delete, and more.
- PowerPoint slide shows: Press the left softkey to switch between notes, outline and slide views. Press **Menu** for options like save, cut, copy, paste, find, delete, and more.
- Word documents: Type numbers or text into the document. Press **Menu** for options like save, cut, copy, paste, find, delete, and more.
- PDF documents: Press the **Zoom** key to change the zoom level. Press the **Menu** key to save a copy of the file, switch pages or other functions.

To **transfer** attachments to your computer for editing, use Microsoft® Exchange ActiveSync or Windows® Mobile Device Centre.

message options

To delete, save, reply or forward the messages, use these quick steps from the Inbox with a message selected or when viewing a message:

- To delete, press **Delete**.
- To reply, press **Menu** > **Reply** or **Reply All**. Enter the message and press **Send**.
- To forward, press **Menu** > **Reply** > **Forward**. Enter the message and press **Send**.
- To create a contact card for the sender, highlight the sender and press the center key  > **Save**.

Tip: Need to check your e-mail right now? Press **Start** > **Messaging**. Select the account to send and receive messages and press **Menu** > **Send/Receive**. The phone connects to your Internet e-mail server and sends and

global address look up

From your phone, you can search the global address list (GAL) stored on your company's Exchange Server. This means that you can find a contact's phone number or e-mail without having to store the information directly to your phone.

Note: GAL information can only be viewed during a data transfer session; the entire GAL cannot be stored for viewing offline.

GAL Lookup can be found from **Contacts** and **Company Directory**. **Company Directory** is found in **Messaging**, **Phone**, **Calendar** and **Speed Dial**. Here is how to use GAL to search for a contact:

- 1 Press **Start** > **Contacts**.
- 2 In the contact list, press **Menu** > **Company Directory**.

3 Scroll through the list of entries that appears. When you locate your contact, press  to make a call.

Note: Although the entire GAL cannot be stored on your phone, once the contact is found, you can add the single contact to your contact list.

Tip: You can also choose to send a message, SMS or e-mail to a contact found using GAL. In a new message or e-mail, press **Menu** > **Company Directory**. When you locate the contact to send a message, highlight and select it. The e-mail information is populated into the **To** field.

messaging quick reference

Note: Some features might not work if you set up your e-mail account manually (without the e-mail setup wizard).



features

send text message

Press **Start** > **Messaging** > **text messages**, then press **New**



features

create and send e-mail

Press **Start** > **Messaging** > (*e-mail account*), then press **New**



Note: You must have your e-mail setup to send an e-mail, see your *Quick Start Guide* to find out how to set up your e-mail.

To add a picture, voice note or file to an e-mail message, open the message area and press **Menu** > **Insert** > **Picture**, **Voice Note**, or **File**.

Tip: You can save a draft of a message that you are composing to finish and send later. Press **Menu** > **Save to Drafts**. A draft of the message is stored in the Drafts folder of the account you are in.

features

create and add an e-mail signature

Press **Start** > **Messaging** > (*e-mail account*), then press **Menu** > **Tools** > **Options** > **Signatures**

Scroll to the account for which you are creating the signature. Select **Use signature with this account**. Select the **Signature** box, enter your signature and press **Done**.

Tip: To insert a signature in every message you send, select **Include when replying and forwarding**. Otherwise, a signature is inserted only in new messages.

read new messages



To quickly view new messages, select the message notification area on the home screen.

features

view attachment







While viewing the message, use the *centre key*  to select the attachment.

Note: You can view attachments only for file types that are supported by the phone.

read old messages

Press **Start** > **Messaging** > (*e-mail account*)



Icons next to each message show if it is **unread** , **read** , **urgent** , or has an **attachment** .

features

reply, reply all or forward messages

From your Inbox or an open message, press **Menu** > **Reply**, **Reply All** or **Forward**



Tip: If you are replying to an e-mail in the e-mail account, you will send less data if you do not edit the original message. This may reduce data transfer costs based on your rate plan.

features

download message objects

If an e-mail message includes an attachment, when you open the message, the name of the attachment will appear highlighted. To download the attachment, select the highlighted attachment name. The attachment is downloaded the next time you synchronise or connect to your e-mail server.



Note: If there are multiple attachments in the message, only the selected attachments are downloaded.

insert a media object in an e-mail

To add a picture, voice note or file in an e-mail message, in the composing message area press **Menu** > **Insert** > **Picture**, **Voice Note** or **File**.

features

download complete e-mail messages

Press **Start** > **Messaging** > (*e-mail account*). Scroll to the message and press **Menu** > **Download Message**.



The complete message is retrieved the next time you synchronise or connect to your e-mail server and send and receive e-mail.

features

mark a folder for synchronisation



When you synchronise your e-mail account with your PC, the same Inbox folders that are in Outlook on your PC are created on your phone.



Press **Start** > **Messaging** > (*e-mail account*), then press **Menu** > **Folders** > **Menu** > **Show All Folders** and press **Menu** > **Manage Folders**

Highlight each folder you want to synchronise and press **Sync**.

Once all folders have been selected, press **Done**. This opens the **Manage Folders** view, where the marked folders will be synchronised during the next sync session.

Note: Only e-mail folders stored on the server are available for sync.

features
<p>view status of sent e-mail</p> <p>Press Start > Messaging > (e-mail account) Menu > Folders > Outbox</p> <p>Messages in the Outbox have not been sent. To send a message, scroll to it and press Menu > Send/Receive.</p>
<p>receive e-mail </p> <p>If your phone is set up to automatically check for new messages, your phone will show  when a new message arrives.</p> <p>Press the  to open the inbox.</p>
<p>delete e-mail</p> <p>From the Inbox or an open e-mail message, press Menu > Delete.</p>



features
<p>manually send and receive e-mail </p> <p>Press Start > Messaging > (e-mail account), then press Menu > Send/Receive.</p>
<p>call a phone number in e-mail </p> <p>Highlight a phone number in a message and press .</p>
<p>move e-mail to personal folder</p> <p>After you are done reading the e-mail, press Menu > Move > (folder).</p>
<p>delete a mail account</p> <p>Press Start > Messaging, scroll to the e-mail account, then press Menu > Delete.</p> <p>Note: You cannot delete your text messages, MMS or Exchange server e-mail accounts.</p>

features
<p>empty deleted items folder</p> <p>Press Start > Messaging > (e-mail account), press Menu > Folders, scroll to Deleted Items, then press Menu > Delete All.</p>

instant messaging

To use instant messaging (IM):

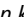
- 1 Press **Start > im**
- 2 Select the IM community you want
- 3 Enter your logon information, if it does not appear.
- 4 Press **SignIn/SignOn**. You will see the status of the groups and individuals you have designated in your IM community.

- To **start** a conversation, highlight the other person, press **Write**, enter text, and press .
- To **switch** to other conversations, press the *navigation key*  left or right.
- To **return** to the previous screen, press **Back**. To return to a conversation, select **Conversations**, select the desired conversation, then press the *center key* .

When you are **in a conversation**, press **Menu** to enter pre-stored text messages as well as emoticons, or to end the conversation.

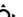
When you are **signed in** but not in a conversation, press **Menu** to manage your contacts or groups, change your status, or sign out. To access other communities, press the *navigation key*  left or right. To store your logon information, press **Menu > Settings > Community Settings**, enter your logon information for each community, then press **Menu > Save**. To change other settings, press **Menu > Settings > Global Settings**.

Note: You can also access MSN Messenger by clicking **Start > Windows Live**.

Bluetooth™ wireless

Your phone supports Bluetooth wireless *pairing* (also called *linking* or *bonding*). You can pair your phone with a Bluetooth headset or car kit or pair your phone with a computer to exchange and synchronise files.

Note: The use of wireless devices and their accessories may be prohibited or restricted in certain areas. Always obey the laws and regulations on the use of these products.

turn Bluetooth power on or off

If Bluetooth **Power** is **On**, your phone can automatically pair with the handsfree device you have used before. Just turn on the

device or move it near the phone. To turn Bluetooth on: Press **Start** > **Bluetooth** > **Bluetooth Manager** > **Settings** then toggle **Status** to **Bluetooth ON**.

The Bluetooth indicator  appears in the home screen.

Note: To extend battery life, use the previous procedure to set Bluetooth **Power** to **Off** when not in use. Your phone will not pair with devices until you set Bluetooth power back to **On** and pair your phone with the devices again.

pair with a headset or handsfree device

Before you try to pair your phone with a device, make sure your phone's Bluetooth power is **on** and the device is **on** and **ready** in *pairing* or *bonding* mode (see the device user's guide). You can pair your phone with multiple devices, but only use it with one headset device at a time.

Your phone lists the devices it finds within range.

- 1 Press **Start** > **Bluetooth** > **Bluetooth Manager** > **Hands-free**.
- 2 Put the device (handsfree headset, stereo headset, keyboard, etc.) in pairing mode.
- 3 Press **Add**. The phone prompts you to verify your device is ready. Press **Search**.

- 4 Select the device from the list.
- 5 If prompted, enter the device passkey (such as 0000) and press the **Accept** key.

When the devices are paired, an icon appears on the home screen in the Bluetooth Task Tray.

Tip: For specific information about the Bluetooth device you are using with your phone, refer to the instructions that came with it.

send objects to another device

You can use Bluetooth pairing to send e-mail, contacts, tasks, calendar items, audio, ring tones, pictures, video and voice notes from your phone to a computer or other device.

- 1 Press **Start** > **Bluetooth** > **BT Send Object**.

- 2 Select the object type and object you want to send.
Tip: To select an item, press the *centre key* .
- 3 Press **Send**.
- 4 Select the name of the device to send the file.
- 5 To cancel sending an item, press **Menu** > **Cancel**.

use your phone as a PC remote

You can use Bluetooth wireless and your phone as a remote control for your computer. For example, want to watch a video on your computer and use your phone as a remote control? Use PC Remote to control when the video plays, stops or pauses.

- 1 On your computer, turn Bluetooth power on.
- 2 On your phone, press **Start** > **Bluetooth** > **BT PC Remote**. If necessary, press **Yes** to turn on Bluetooth power.
- 3 Press **Add**.
- 4 On your computer, right-click on the Bluetooth indicator  in the system tray in the lower right corner of your display. Select **Bluetooth Setup Wizard**.
- 5 In the wizard, indicate that you know the service you want to use and you want to find a Bluetooth device that provides the service. Select **Next**.
- 6 In the next window, choose **Human Interface Device** or **PC Remote** and select **Next**.

- 7 In the next window, make sure that "Show all devices" is chosen in the pull-down menu. Your computer should find your "SmartPhone." Make sure the box "Allow other Bluetooth devices to see this phone" is checked. Select your phone and select Next.
- 8 If prompted, enter the device passkey (such as 0000) and press the **Accept** key.

When PC Remote is connected, your phone display shows a key map that tells you what your keys control on the PC. To determine which program on your computer to control, on your phone, press **Menu** and select a program.

advanced Bluetooth features

features
make phone visible to other device Allow a Bluetooth device to discover your phone:  Press Start > Bluetooth > Bluetooth Manager > Settings and check Allow other Bluetooth devices to see this phone
connect to recognised device  Connect to a recognised handsfree device: Press Start > Bluetooth > Bluetooth Manager > Hands-free > device name
drop pairing with device  Press Start > Bluetooth > Bluetooth Manager > Hands-free > device name > Disconnect

notification. For more information, select **View status**. Synchronisation will resume when there is network coverage.

sync with a computer

You can use Microsoft® **ActiveSync version 4.5 or above** or Windows® **Mobile Device Centre** to synchronise information between your phone and desktop computer. ActiveSync compares your phone's contact information, calendar appointments, e-mail messages and media files to those on your computer and then updates to the most recent information.

installing and setting up ActiveSync

To synchronise information on your phone with a PC, you must use Windows® Mobile Device Center (on a PC running Windows Vista) or install Microsoft ActiveSync (on a PC running Windows XP™ or earlier).

Note: Synchronisation software is included on the *Getting Started CD* packed with your phone. Before installing the software, verify that your computer and operating system meet the **minimum requirements** stated on the CD-ROM sleeve or Microsoft Windows® Mobile Web site (<http://www.microsoft.com/windowsmobile>). This Web site also lets you download the **latest software** for ActiveSync.

- 1 Install Microsoft ActiveSync (for Windows® XP™ or earlier) or Windows Mobile Device Centre (for Windows Vista) on your PC.
- 2 After setup completes, connect your phone to the PC. The phone drivers install on your computer and then the Sync Setup Wizard automatically starts.
- 3 Follow the instructions on the screen to complete the wizard.

features
send object to device  Send an object to another device: Press Start > Bluetooth > BT Send Object
edit device properties / change device name  Edit the properties of a recognised device: Press Start > Bluetooth > Bluetooth Manager > Hands-free > device name , then press Menu > Properties > Nickname Tip: To change the Bluetooth name of your phone, press Start > Bluetooth > Bluetooth Manager > Settings and enter the name in My Bluetooth name .

The wizard prompts you for the Exchange Server's name, your user name, your password and the domain name. If you do not have this information, contact the server's system administrator. For general questions about your phone, see page 89.

When you finish the wizard, ActiveSync starts to synchronise automatically with your phone.

Note: Once synchronisation completes, you can disconnect your phone from your PC and you may need to restart your PC.

synchronising with a cable connection

Once Microsoft® ActiveSync or Windows® Mobile Device Center is installed

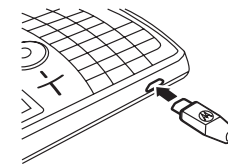

synchronise

You can synchronise the information on your phone in two ways, over the air (OTA) or using a cable and your computer.

sync over the air

To sync your phone over the air (OTA) you must sync it directly with your company's Microsoft® Information Server or Microsoft® Exchange Server (running the appropriate version software). For more information about this set-up, see the support information on page 89 and the Motorola support Web site at: www.motorola.com/support/9h.

You can also contact your system administrator to set up this synchronisation.

Note: If you are out of network coverage and your phone tries to sync 3 times without finding a network, you will receive a

on your PC, you can connect it to your phone and sync.

- 1 Turn on the phone.
- 2 Connect your phone to your PC using a USB cable. 

Note: For more detailed information, see "Connecting a mobile device to a PC" in ActiveSync Help on your PC, the Microsoft Web Site for ActiveSync or the Motorola support Web site at www.motorola.com/support/9h

synchronising with a Bluetooth™ connection

Once Microsoft® ActiveSync or Windows® Mobile Device Center is installed on your PC, you can connect it to your phone and sync with a Bluetooth connection.

Note: In order to use this feature, your PC must be equipped with Bluetooth wireless or a Bluetooth PC adaptor accessory.

- 1 Follow the instructions in ActiveSync Help for configuring Bluetooth connections on your PC to support ActiveSync.
- 2 Turn on the phone.
- 3 On your phone, verify that Bluetooth wireless is turned on (Press **Start** > **Bluetooth** > **Bluetooth Manager** > **Settings** > **Status** > **Bluetooth ON**).
- 4 Press **Start** > **Settings** > **Connections** > **USB Device Type**.
- 5 Press **Start** > **ActiveSync**.
- 6 Select **Menu** > **Connect via Bluetooth**. Ensure that the phone and PC are within close range. If this is the first time you have connected to this PC using Bluetooth wireless, you must complete the

66 connections

you must install networking drivers onto your computer.

On your computer:

- 1 Place the provided Getting Started Disc into the CD Drive on your computer. Your computer automatically launches the Getting Started Disc.
Note: If you do not have the Getting Started Disc or want the latest version of the device and computer drivers, go to www.motorola.com/support/9h.
- 2 In the Getting Started Disc application, go to the Additional Tools screen and select the **Dial-Up Networking Software**.
- 3 Follow the prompts as directed to install the drivers onto your computer.

68 connections

Bluetooth wizard on the phone and set up a Bluetooth partnership with the PC before synchronising.

- 7 Select **Sync**.
- 8 When finished, select **Menu** > **Disconnect Bluetooth**. To conserve battery power on your phone, turn off Bluetooth power (see page 59).

modem-link

You can use your phone as a modem to dial in to a network. To do this, you need a Bluetooth™ wireless or USB cable connection.

Note: When you activate your phone as a modem-link, your phone's e-mail, Web browsing, Microsoft® ActiveSync and text messaging services are suspended until you deactivate the modem-link.

On your phone:

Now, you need to enable modem-link on your phone and install phone drivers:

- 4 On your phone, press **Start** > **Settings** > **Connections** > **USB Device Type** > **Modem** and press **Done**.
- 5 Using the USB data cable, connect the phone to your PC.

The driver is installed on your computer and ready for setting up a network connection.

On your computer:

After you set up your computer and phone, you can establish a new network connection on your computer:

Note: This procedure might not work on all computers. Please refer to your computer operating help system for more information.

modem-link with Bluetooth™ wireless

To use Bluetooth wireless to modem-link to a network:

Note: You must have a computer that has Bluetooth capabilities for modem-link to work with Bluetooth wireless.

- 1 To make sure other Bluetooth devices can find your phone, you must first turn on Bluetooth wireless. To do this on your phone, press **Start** > **Bluetooth** > **Bluetooth Manager** > **Settings** then toggle **Status** to **Bluetooth ON**. See Bluetooth wireless on page 59 for more information.
- 2 On your computer, launch the Bluetooth devices applet from the task bar.
Note: Not all computers have the same procedure to locate the Bluetooth window and setup of dial-up networking.

- 6 Right-click on **My Computer** and select **Properties**.
- 7 Select the **Hardware** tab.
- 8 Press the **Device Manager** button.
- 9 Expand the **Modems** list.
- 10 Right-click **Smartphone Wireless USB Modem** and select **Properties**.
- 11 Select the **Advanced** tab and enter extra initialisation commands required by your service provider. For details, contact your service provider.
- 12 Select **Start** > **Control Panel** > **Network and Internet Connections** > **Network Connections**. In the Network Connections window, select **Create a new connection** under Network Tasks.

Please refer to your computer operating help system for more information.

- 3 On your computer, right-click the Bluetooth icon in the Windows task bar, select the **Quick Connect** menu, **Dial-up Networking** and then **Find devices**.
- 4 The computer finds your phone and shows the dial up networking window. Make sure the box "Allow other Bluetooth devices to see this phone" is checked.

Now you can use your phone as a modem to connect to a service provider or network.

modem-link with a cable

Note: Do not connect your data cable to your phone and computer until the following steps tell you to do so.

To use a USB cable with your phone to connect with modem-link to a network, first

connections 67

- 13 Follow the prompts to connect to the Internet using a modem:
 - Network Connection Type: **Connect to the Internet**
 - Getting Ready: **Set up My Connection Manually**
 - Internet Connection: **Connect using a dial-up modem**
 - Connection Name: Enter a unique identifier for ISP name.
 - Number to Dial: ***99#**
 - Connection Availability: **Anyone's Use**
 - User Name: get this information from your service provider as required
 - Password: get this information from your service provider as required

connections 69

- If you do not plan to use your phone as the default Internet connection, then **do not** check **Make this the default Internet connection**.
- If Microsoft® Windows® firewall is not enabled, **do not** check **Turn on Internet connection firewall for this connection**.

Note: You might need to deactivate your computer proxy server settings to let modem-link access the Internet. To deactivate these settings, open your Web browser and select **Menu > Tools > Internet Options > Connections > Settings > Proxy Server**, then deselect **Use a proxy server for this connection**.

disconnect modem-link

To disconnect modem-link, you'll need to perform steps on your computer and your phone. On your computer:

- 1 Go to task bar and right-click on the Network Connection icon.
- 2 Select **Disconnect**.

Your computer disconnects the modem-link.

On your phone, to return your phone to ActiveSync mode for USB connections, press **Start > Settings > Connections > USB Device Type > ActiveSync**.

Note: Once you are no longer using modem link, you may need to reactivate your computer's proxy settings. Please check with your Internet provider.

web browser

You can use the browser to search and view the Web.

Find it: Press **Start > Web Browser**

Your browser homepage appears.

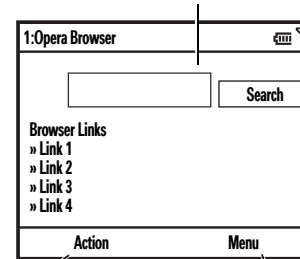

Press **Action** to open navigation options.

Press **Menu** to change browser settings and other options

Note: Not all Web file formats are supported.

- To go to a Web page, press **Action > Go to**. Enter the address and press **Done**.
- To go to a link in a Web page, use the *navigation key* to highlight the link and then press the *centre key*.
- To change connection options, press **Menu > Tools > Settings > Connections**.
- To show/hide pictures, press **Menu > Display > Load images**.
- To add a Web address to your Favorites, open the Web page and press **Action > Bookmark this page**.

Tip: All finished? When you are done with the browser, press **Menu > Exit** to close the browser and conserve battery life

take & send a photo

Press **[Camera]** to open the camera viewfinder:

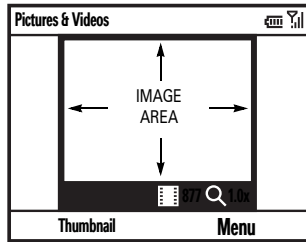

Tip: In the camera viewfinder, press **Menu** to adjust picture settings such as **mode**, **brightness**, **resolution**, **zoom**, **white balance** and **flash**.

- 1 Point the camera lens at the photo subject.
- 2 Press **[Camera]** or the *centre key* to take a photo. Your phone saves the picture and shows it in the viewfinder.
- 3 Close the viewfinder or open the camera options menu.

To close the viewfinder, press **[Camera]**. You can see your stored picture by pressing **Start > Pictures & Videos**.

To see other camera options, press **Menu**:

- To delete the photo and return to the active viewfinder, select **Delete**.
- To send the photo via **MMS**, select **Send > MMS**

- To send the photo with **E-mail**, select **Send > E-mail**.
- To send the photo with Bluetooth™ wireless, select **Send via Bluetooth**.
- To use the picture as the home screen, select **Use as Home Screen**.
- To edit the picture, select **Edit**.
- To view image properties, like the filename, select **Properties**.
- To view picture option, select **Options**.

Note: To see your stored pictures, press **Start > Pictures & Videos**. Select the picture to view and press **View**.

Tip: To view pictures located in a folder other than the default pictures folder, including a storage card, press **Start > Pictures & Videos**, then press **Menu > Folders** and select the folder that contains stored pictures.

self portrait

- 1 Press **[Camera]** to activate the camera.
- 2 Press **Menu > Mode > Timer**.
- 3 Press **[Camera]** to start the 5 second delay.
- 4 Aim the camera lens at yourself.
- 5 When you hear the camera shutter sound, your phone takes the photo and shows it in the viewfinder.

picture options

In the picture viewfinder press **Menu > Options** to open the **Picture Options Menu**. This menu can include the following options:

option
General
Determine default picture sizes for e-mail and rotating picture settings.

option
Slide Show
Select default slide show settings.
Camera
Select default locations to store pictures, filename prefixes and image compression.
Video
Determine audio settings and time limits for video files.

record & play video clip

record a video clip

Find it: Press **[Camera]**, then **Menu > Video**

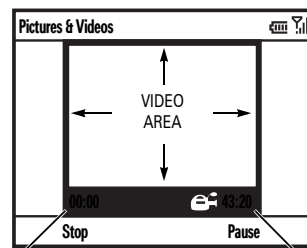

Remaining recording time Current recording length

Tip: In the video viewfinder, press **Menu** to adjust video settings such as **brightness**, **quality** and **white balance**.

- 1 Point the camera lens at the photo subject.
- 2 Press **[Camera]** or the *centre key* to begin recording a video. The viewfinder shows what the video is recording.
- 3 Press **Stop** to end recording the video altogether or press **Pause** to pause recording and **Resume** to continue recording.

Note: Videos are automatically stored in your phone. To view them, press **Start > Pictures & Videos**. Select the video to view and press **Play** or the *centre key*.

Tip: To view videos located in a folder other than the default video folder, including a storage card, press **Start > Pictures & Videos**, then press **Menu > Folder** and then select the folder that contains the stored videos.

video options

In the video viewfinder press **Menu > Options** to open the video options menu:

option
Camera
Select default save locations, video filename prefixes and image compression.
Video
Determine audio and time limit settings for video files.

Note: **General** and **Slide Show** options are also available in this menu, however these settings are specific to picture files only.

play a video clip

For more video playback and Windows® Media Player features, see your *Quick Start Guide*.

Find it: Press **Start > Pictures & Videos > video clip > Play**

The video clip plays in the **Windows Media Player**.

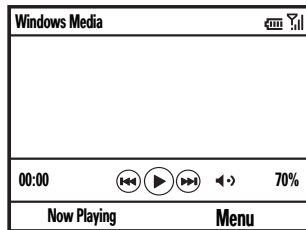

Tip: To play video in full screen mode, press **Menu > Full Screen**. Videos recorded in a low resolution may not play in full screen mode.

If a call comes in while watching a video, the video pauses and a call alert appears. You can choose to answer the call or ignore it. To continue watching the movie, select the **Play** button.



video playback options

In the video playback window press **Menu > Options** to open the **Video Playback Menu**. This menu can include the following options:

option
Play Video Determines how the time counter appears, whether to pause playback while using another program and whether to resume playback after a phone call.
Video Options for showing in full screen and when to scale to fit window.
Network Selects default network settings for streaming media.



option
Library Determines if the player starts on the Library view.
Skins Determine Windows® Media Player skin theme.
Buttons Set playback button mapping.

other features



Note: To open the main menu from your home screen, press **Start**. To scroll through the pages of menu options, press the *navigation key*  down. To select a menu option, press the *centre key* .

advanced calling

features
call forwarding 
Set up or cancel call forwarding:
Press Start > Settings > Phone > Call Forwarding
Note: If you choose No Reply , you can set how many seconds your phone waits before it forwards a call.

features
voice dial
To voice dial, press and hold  in your home screen. When prompted, say "Call", followed by a number or contact name.
TTY calls 
Set up your phone for use with an optional TTY device:
Press Start > Settings > Phone Accessibility > TTY
Note: A teletypewriter (TTY) is a communication device used by people who are hard of hearing or have a speech impairment. TTY does not work from mobile phone to mobile phone.

features
set picture ID for contact
Note: You cannot store a picture ID for SIM Contacts.
Assign a photo or picture to appear when you receive a call from an entry:
Press Start > Contacts , scroll to a contact, then press Menu > Edit > Picture
Select a picture or select Camera to take a new picture for the contact.
Tip: Want to remove a picture ID? Press Start > Contacts , scroll to a contact, press Menu > Edit , then press Menu > Remove Picture
set category for contact
Note: You cannot store a category for SIM Contacts.
Press Start > Contacts , scroll to a contact, then press Menu > Edit > Categories

features
call a phone number in a message 
E-mail or text messages can contain phone numbers that have an underline, like a Web site hyperlink. To dial one of these numbers, scroll to it and press  .

contacts

To store and call contacts, see page 26.

features
search for contact
Enter the first few letters of the contact's name. The phone searches through the contact list and shows the name.
edit contact
Press Start > Contacts , scroll to a contact, then press Menu > Edit

features
set ringer ID for a contact
Note: You cannot store a ringer ID for SIM Contacts.
To easily identify who is calling you by the ring tone, you can assign a custom ring tone to each contact.
Press Start > Contacts , scroll to a contact, then press Menu > Edit > Custom ring tone

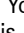
features
set category view
Press Start > Contacts , then press Menu > Filter
send contact to another device
Use a Bluetooth™ connection to send a contact to another phone, computer or device:
Press Start > Contacts , scroll to a contact and press Menu > Send via Bluetooth
If necessary, your phone asks you to turn on Bluetooth power. Your phone searches for Bluetooth devices. Select the one you want and press the <i>centre key</i>  . Your phone tells you when the transfer is complete.
For more about Bluetooth connections, see page 59.

personalising

features
language
Set menu language:
Press Start > Settings > Regional Settings
Note: You must turn your phone off and on again for the changes to take effect.
Tip: While you enter text (such as in a text message), your phone suggests words. To change the language for these suggestions, press Menu > Languages in the text entry screen.
accessibility
You can set system font size, multipress timeout, confirmation timeout and in-call alerts:
Press Start > Settings > Accessibility

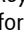
features
ring volume
Press Start > Settings > Profiles
Highlight the desired profile, then press Menu > Edit
Under Ringer Volume , press the <i>navigation key</i>  left or right to adjust the volume for that profile.
Tip: You can eliminate the ringer volume instantly when an incoming call comes in—just use the <i>side scroll keys</i> to turn the ringer off.

features
sounds
To change the default sounds for ring tone, reminders, new messages, alarm clock or keypad controls: Press Start > Settings > Sounds
Note: Changes made to the alert settings will have no effect when using the Silent profile.
alarm
Press Start > Settings > Clock Alarm > Alarm
Tip: Need to change or set the alarm alert style? Press Start > Settings > Sounds > Alarm Clock .

features
owner information
It's a good idea to enter and check your owner information. It lets someone return the phone to you if you lose it: Press Start > Settings > Owner Information
master reset
To return your phone to original settings: Press Start > System Tools > Master Reset
The default master reset code is 000000 (6 zeroes).
Master reset does not reset the unlock code, security code and lifetime timer.

features
master clear
Caution: Master clear erases all information you have entered (including contacts and calendar events) and content you have downloaded (including photos and sounds) stored in your phone's memory. After you erase the information, you cannot recover it. Press Start > System Tools > Master Clear

call times



Network connection time is the elapsed time from the moment you connect to your service provider's network to the moment you end the call by pressing .

The amount of network connection time you track on your resettable timer may not equal the amount of time for which you are billed by your service provider. For billing information, contact your service provider.

features
see call timers 
Show call timers: Press Start > Call History , then press Menu > View Timers
reset call timers
To reset all call timers to zero (0), except for the Lifetime calls timer: Press Start > Call History , then press Menu > View Timers , then press Menu > Reset Timers

handsfree

Note: The use of wireless phones while driving may cause distraction. Discontinue a call if you cannot concentrate on driving. Additionally, the use of wireless devices and their accessories may be prohibited or restricted in certain areas. Always obey the laws and regulations on the use of these products.

features
speakerphone 
Activate a connected external speakerphone during a call: Press  or press Menu > Speakerphone On .
Note: With a Bluetooth™ headset press Menu > Hands-free Off and then press Menu > Speakerphone On .

network connections

features
create proxy, Virtual Private Network (VPN) or dial-up network 
A Virtual Private Network lets you connect securely to your enterprise through IPsec. This connection requires a policy definition from your IT department. Your IT department can send you the policy in a file or give you the policy to enter manually. Once you receive the policy file or information: Press Start > Virtual Private Network
Select a policy to open a connection or press Menu > New to enter a new policy definition.
To close the secure connection, press Logoff .

calendar

features
add new calendar event
Press Start > Calendar , then press Menu > New Appointment
Note: To schedule an all-day event, select the All day event check box under End time . All-day events do not occupy blocks of time in the calendar; instead, they appear in banners at the top of the calendar.

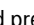
features
view calendar event
Press Start > Calendar to open the calendar for today. <ul style="list-style-type: none"> To see days before or after today, press the <i>navigation key</i>  left or right. To quickly see a specific date, press Menu > Go to Date. To see your whole week's events, press Week.
Shortcut: Today's events appear on your home screen. To see event details, scroll to it and press the <i>centre key</i>  .

features
<p>calendar event reminder</p> <p>The default reminder time for tasks and calendar items is 15 minutes. To change this default:</p> <p>Press Start > Calendar, then press Menu > Tools > Options > Set reminders</p>
<p>send calendar event to another device</p> <p>Use a Bluetooth™ connection to send a calendar event to another phone, computer or device:</p> <p>From the calendar item, press Menu > Send via Bluetooth.</p> <p>Select the device to which you want to send the item.</p> <p>For more about Bluetooth connections, see page 59.</p>

features
<p>respond to a meeting request</p> <p>You can receive and respond to meeting requests on your phone in a similar manner as you do in Outlook on your PC.</p> <p>Press Start > Messaging > (<i>e-mail account</i>) > <i>meeting request</i></p> <p>Press Accept or Menu > Decline or Tentative</p>

calculator

features
<p>calculator</p> <p>Press Start > Accessories > Calculator</p>

security

features
<p>manage certificates </p> <p>Enable or disable Internet access certificates stored on your phone:</p> <p>Press Start > Settings > Security > Certificates</p> <p>Certificates are used to verify the identity and security of Web sites when you download files or share information.</p>

phone information

features
<p>software version</p> <p>To view your phone software version:</p> <p>Press Start > Settings > About</p>

features
<p>memory & storage</p> <p>To see the total, used and available memory on your phone and storage card:</p> <p>Press Start > System Tools > Memory Manager</p>

fun & games

features
<p>access pictures</p> <p>Manage pictures:</p> <p>Press Start > Pictures & Videos</p>

features
<p>access sounds</p> <p>Manage ring tones and music that you have downloaded or composed:</p> <p>Press Start > Windows Media</p> <p>For more information about Windows® Media, see your <i>Quick Start Guide</i>.</p>
<p>access video clips</p> <p>Manage video clips:</p> <p>Press Start > Pictures & Videos</p> <p>For more information about Windows® Media, see your <i>Quick Start Guide</i>.</p>
<p>play games on your phone</p> <p>Press Start > Games</p>

features
<p>start Web browser </p> <p>Press Start > Opera</p> <p>For more information about the Opera browser, see page 71.</p>
<p>close Web browser</p> <p>In the browser, press Menu > Exit</p>
<p>download objects from Web page </p> <p>To download a picture, sound or phone theme from a Web page: Highlight the file, press the Select key, then press the Store key.</p> <p>To download a picture or other object from a Web page: Highlight the item, press Menu and choose an option such as Save image.</p>

Support & service

Tip: Motorola Software Update is an easy way to update your phone. Make sure you have the latest available software updates at www.motorola.com/support/9h.

If you have questions or need assistance, we're here to help.

Motorola Support:

Go to www.motorola.com/support/9h, where you can select from a number of customer care options. Motorola Software Update is an easy way to update your phone. Make sure you have the latest available software updates at www.motorola.com/support/9h.

Microsoft® Windows® Mobile and ActiveSync Support:

Windows Mobile:
<http://www.microsoft.com/windowsmobile/help/smartphone/>

Specific Absorption Rate Data

This model meets international guidelines for exposure to radio waves.

Your mobile device is a radio transmitter and receiver. It is designed not to exceed the limits for exposure to radio waves recommended by international guidelines. These guidelines were developed by the independent scientific organization ICNIRP and include safety margins designed to assure the protection of all persons, regardless of age and health.

The guidelines use a unit of measurement known as the Specific Absorption Rate, or SAR. The ICNIRP SAR limit for mobiles devices used by the general public is 2 W/kg and the highest SAR value for this device when tested at the ear was 0.74 W/kg.¹ As

mobile devices offer a range of functions, they can be used in other positions, such as on the body as described in this user guide.² In this case, the highest tested SAR value is 0.59 W/kg.¹

As SAR is measured utilising the device's highest transmitting power, the actual SAR of this device while operating is typically below that indicated above. This is due to automatic changes to the power level of the device to ensure it only uses the minimum level required to reach the network.

While there may be differences between the SAR levels of various phones and at various positions, they all meet the governmental requirements for safe exposure. Please note that improvements to this product model could cause differences in the SAR value for later products; in all cases, products are designed to be within the guidelines.

The World Health Organization has stated that present scientific information does not indicate the need for any special precautions for the use of mobile devices. They note that if you want to reduce your exposure then you can do so by limiting the length of calls or using a "hands-free" device to keep the mobile phone away from the head and body.

Additional Information can be found on the websites of the World Health Organization (<http://www.who.int/emf>) or Motorola, Inc. (<http://www.motorola.com/rfhealth>).

-
1. The tests are carried out in accordance with international guidelines for testing. The limit incorporates a substantial margin for safety to give additional protection for the public and to account for any variations in measurements. Additional related information includes the Motorola testing protocol, assessment procedure, and measurement uncertainty range for this product.
 2. Please see the **Safety and General Information** section about body worn operation.

Information from the World Health Organisation

Present scientific information does not indicate the need for any special precautions for the use of mobile phones. If you are concerned, you may want to limit your own or your children's RF exposure by limiting the length of calls or by using handsfree devices to keep mobile phones away from your head and body.

Source: WHO Fact Sheet 193

Further information: <http://www.who.int/peh-emf>

Microsoft End User License Agreement

You have acquired a device ("DEVICE") that includes software licensed by Motorola, Inc. ("Motorola") from one or more third-party licensors ("Licensor"), for use in connection with wireless network services provided under separate agreement between you and a wireless telecommunications provider ("Mobile Operator"). Those installed software products provided by Licensor, as well as associated media, printed materials, and "online" or electronic documentation ("SOFTWARE") are protected by international intellectual property laws and treaties. SOFTWARE includes software already installed on the DEVICE ("DEVICE Software") and Licensor software contained on any CD-ROM disk accompanying the DEVICE ("Desktop Software").

The SOFTWARE is licensed, not sold. All rights reserved.

IF YOU DO NOT AGREE TO THIS END USER LICENSE AGREEMENT ("EULA"), DO NOT USE THE DEVICE OR COPY THE SOFTWARE. INSTEAD, PROMPTLY CONTACT MOTOROLA FOR INSTRUCTIONS ON RETURN OF THE UNUSED DEVICE(S) FOR A REFUND. ANY USE OF THE SOFTWARE, INCLUDING BUT NOT LIMITED TO USE ON THE DEVICE, WILL CONSTITUTE YOUR AGREEMENT TO THIS EULA (OR RATIFICATION OF ANY PREVIOUS CONSENT).

8. Termination. Without prejudice to any other rights, Motorola, Licensor and their affiliates and subsidiaries may terminate this EULA if you fail to comply with the terms and conditions of this EULA. In such event, you must destroy all copies of the SOFTWARE and all of its component parts.

9. Security Updates. The SOFTWARE may include digital rights management technology. If SOFTWARE does contain digital rights management technology, content providers are using the digital rights management technology ("Licensor DRM") contained in the SOFTWARE to protect the integrity of their content ("Secure Content") so that their intellectual property, including copyright, in such content is not misappropriated. Owners of such Secure Content ("Secure Content Owners") may, from time to time, request Licensor, or its subsidiaries or affiliates to provide security related updates to the Licensor DRM components of the SOFTWARE ("Security Updates") that may affect your ability to copy, display and/or play Secure Content through Licensor software or third party applications that utilize Licensor DRM. You therefore agree that, if you elect to download a license from the Internet which enables your use of Secure Content, Licensor, its subsidiaries or affiliates may, in conjunction with such license, also download onto your DEVICE such Security Updates that a Secure Content Owner has requested that Licensor, its subsidiaries or affiliates, to distribute. Licensor, its subsidiaries or affiliates will not retrieve any personally identifiable information, or any other

1. GRANT OF SOFTWARE LICENSE. This EULA grants you the following license:

1.1. DEVICE Software. You may use the DEVICE Software as installed on the DEVICE (including as installed on removable media installed in the DEVICE). All or certain portions of the DEVICE Software may be inoperable if a proper account is not established or maintained with an appropriate Mobile Operator, or if the Mobile Operator's network facilities are not operating or configured to operate with the DEVICE software.

1.2. Desktop Software. If Desktop Software is included with your DEVICE, you may install and use the Desktop Software on one (1) or more computers to exchange information with one (1) or more computing devices that contain a compatible version of the DEVICE Software. For other software component(s) contained in the Desktop Software, you may install and use such components only in accordance with the terms of the printed or online end user license agreement(s) provided with such component(s). In the absence of an end user license agreement for particular component(s) of the Desktop Software, you may install and use only one (1) copy of such component(s) on the DEVICE or a single computer with which you use the DEVICE.

1.3. Back-up Copy. If Motorola has not included a back-up copy of the DEVICE Software with the DEVICE, you may make a single back-up copy of the DEVICE Software. You may use the back-up copy solely for archival purposes.

1.4. Microsoft Windows® 2003. If Microsoft Outlook® 2002 is included with your Device, the following terms apply to your use of Microsoft Outlook® 2002: (i) regardless of the information contained in "Software Installation and Use" section of the online EULA you may install one (1) copy of Microsoft Outlook® 2002 on one (1) computer to use, exchange data, share data, access and interact with the DEVICE, and (ii) the EULA for Microsoft Outlook® 2002 is between Motorola and the end user - not between the PC manufacturer and end user.

2. Speech/Handwriting Recognition. If the Software includes speech and or handwriting recognition component(s), you should understand that speech and handwriting recognition are inherently statistical processes; that recognition errors are inherent in the processes; that it is your responsibility to provide for handling such errors and to monitor the recognition processes and correct any errors. Motorola, its affiliates, subsidiaries, or suppliers shall not be liable for any damages arising out of errors in the speech and handwriting recognition processes.

3. Limitations on Reverse Engineering, Decompilation and Disassembly. You may not reverse engineer, decompile, or disassemble the SOFTWARE, except and only to the extent

that such activity is expressly permitted by applicable law notwithstanding this limitation.

4. Single DEVICE. The Device Software is licensed with the DEVICE as a single integrated product. The DEVICE Software may only be used as part of the DEVICE, notwithstanding any installation of the DEVICE Software on removable media.

5. Single EULA. The package for the DEVICE may contain multiple versions of this EULA, such as multiple translations and/or multiple media versions (e.g., in the user documentation and in the software). Even if you receive multiple versions of the EULA, you are licensed to use only one (1) copy of the DEVICE Software.

6. Rental. You may not rent or lease the SOFTWARE.

7. Software Transfer. You may not permanently transfer any of your rights under this EULA with regard to the DEVICE Software or Desktop Software, except as permitted by the applicable Mobile Operator. In the event that the Mobile Operator permits such transfer, you may permanently transfer all of your rights under this EULA only as part of a sale or transfer of the DEVICE, provided you retain no copies, you transfer all of the SOFTWARE (including all component parts, the media and printed materials, any upgrades or backup copies, this EULA and, if applicable, the Certificate(s) of Authenticity), and the recipient agrees to the terms of this EULA. If the Software is an upgrade, any transfer must include all prior versions of the SOFTWARE.

information, from your DEVICE by downloading such Security Updates.

10. Consent to Use of Data. You agree that Licensor, its subsidiaries and affiliates may collect and use technical information gathered in any manner as part of product support services related to the SOFTWARE.. Licensor, its subsidiaries and affiliates may use this information solely to improve their products or to provide customized services or technologies to you. Licensor, its affiliates and subsidiaries may disclose this information to others, but not in a form that personally identifies you.

11. Internet Gaming/Update Features. If the SOFTWARE provides, and you choose to utilize, the Internet gaming or update features within the SOFTWARE, it is necessary to use certain computer system, hardware, and software information to implement the features. By using these features, you explicitly authorize Licensor, its subsidiaries and affiliates, and/or their designated agent to use this information solely to improve their products or to provide customized services or technologies to you. Licensor, its subsidiaries and affiliates may disclose this information to others, but not in a form that personally identifies you.

12. Internet-Based Services Components. The SOFTWARE may contain components that enable and facilitate the use of certain Internet-based services. You acknowledge and agree that Licensor, its affiliates and subsidiaries may automatically check the version of the SOFTWARE and/or its components that you are utilizing and my provide

upgrades or supplements to the SOFTWARE that may be automatically downloaded to your Device.

13. Links to Third Party Sites. The SOFTWARE may provide you with the ability to link to third party sites through the use of the SOFTWARE. The third party sites are NOT under the control of Motorola, Licensor, or their affiliates or subsidiaries. Neither Motorola, Licensor, nor their affiliates or subsidiaries are responsible for (i) the contents of any third party sites, any links contained in third sites, or any changes or updates to third party sites, or (ii) webcasting or any other form of transmission received from any third party sites. If the SOFTWARE provides links to third party sites, those links are provided to you only as a convenience, and the inclusion of any link does not imply an endorsement of the third party site by Motorola, Licensor, or their affiliates or subsidiaries.

14. Additional Software/Services. The SOFTWARE may permit Motorola, Licensor, their affiliates or subsidiaries to provide or make available to you SOFTWARE updates, supplements, add-on components, or Internet-based services components of the SOFTWARE after the date you obtain your initial copy of the SOFTWARE ("Supplemental Components").

14.1. If Motorola, or its subsidiaries or affiliates, provides or makes available to you Supplemental Components and no other EULA terms are provided along with the Supplemental Components, then the terms of this EULA shall apply.

14.2. If Licensor, or its affiliates or subsidiaries, make available Supplemental Components, and no other EULA terms are provided, then the terms of this EULA shall apply, except that the Licensor, or its affiliates or subsidiaries providing the Supplemental Component(s) shall be the licensor of the Supplemental Component(s).

14.3. Motorola, Licensor, and their affiliates and subsidiaries reserve the right to discontinue any Internet-based services provided to you or made available to you through the use of the SOFTWARE.

15. UPGRADES AND RECOVERY MEDIA.

15.1. DEVICE Software. If the DEVICE Software is provided by Motorola, its subsidiaries or affiliates, separate from the DEVICE on media such as a ROM chip, CD ROM disk(s) or via web download or other means, and is labeled "For Upgrade Purposes Only" or "For Recovery Purposes Only", you may install one copy of such DEVICE Software on the DEVICE as a replacement copy for the existing DEVICE Software and use it in accordance with the Grant of Software License section of this EULA.

15.2. Desktop Software. If any Desktop Software component(s) is provided by Motorola, its subsidiaries or affiliates, separate from the DEVICE on CD ROM disk(s) or via web download or other means, and labeled "For Upgrade Purposes Only" or "For Recovery Purposes Only", you may (i) install and use one copy of such component(s) on the computer(s) you use to exchange data with the

DEVICE as a replacement copy for the existing Desktop Software component(s).

16. COPYRIGHT. All title and intellectual property rights in and to the SOFTWARE (including but not limited to any images, photographs, animations, video, audio, music, text and "applets", incorporated into the SOFTWARE), the accompanying printed materials, and any copies of the SOFTWARE, are owned by Motorola, Licensor, and/or their affiliates, subsidiaries, or suppliers. You may not copy the printed materials accompanying the SOFTWARE. All title and intellectual property rights in and to the content which may be accessed through use of the SOFTWARE is the property of the respective content owner and may be protected by applicable copyright or other intellectual property laws and treaties. This EULA grants you no rights to use such content. All rights not specifically granted under this EULA are reserved by Motorola, Licensor, their affiliates, subsidiaries, and suppliers.

17. EXPORT RESTRICTIONS. You acknowledge that SOFTWARE is subject to U.S. export jurisdiction. You agree to comply with all applicable international and national laws that apply to the SOFTWARE, including the U.S. Export Administration Regulations, as well as end-user, end-use and destination restrictions issued by U.S. and other governments.

18. PRODUCT SUPPORT. Product support for the SOFTWARE is NOT provided by Licensor, its parent corporation, or their affiliates or subsidiaries.

19. NO LIABILITY FOR CERTAIN DAMAGES. EXCEPT AS PROHIBITED BY LAW, MOTOROLA, LICENSOR, AND THEIR AFFILIATES AND SUBSIDIARIES, SHALL HAVE NO LIABILITY FOR ANY INDIRECT, SPECIAL, CONSEQUENTIAL OR INCIDENTAL DAMAGES ARISING FROM OR IN CONNECTION WITH THE USE OR PERFORMANCE OF THE SOFTWARE. THIS LIMITATION SHALL APPLY EVEN IF ANY REMEDY FAILS OF ITS ESSENTIAL PURPOSE.

20. FOR APPLICABLE LIMITED WARRANTIES AND SPECIAL PROVISIONS PERTAINING TO YOUR PARTICULAR JURISDICTION, PLEASE REFER TO YOUR WARRANTY BOOKLET INCLUDED WITH THIS PACKAGE OR PROVIDED WITH THE SOFTWARE PRINTED MATERIALS.

index

A

- accessibility 81
- accessories 22, 84
- accessory connector port 3
- ActiveSync 64
- alarm 82
- alert
 - set 37
 - turn off 34, 42, 71
- animation 87
- answer a call 26, 40
- attachments 53
- auto-lock
 - phone 35

B

- background 39
- backlight 40

98 index

- message indicator 31, 48
- message reminders 82
- messages 48, 52
 - e-mail 48
 - text 48
- missed call 43
- Missed Calls message 43
- modem 67
- multimedia message 48, 53, 54
- music 88

N

- navigation key 2, 3
- network settings 84
- networking 67
- number. See phone number
- numbers 32
- numeric entry mode 32

- battery 23

- extending battery life 24
- battery indicator 31
- battery life, extending 40, 59
- Bluetooth connection 80, 86
- Bluetooth indicator 31
- Bluetooth remote 61
- Bluetooth wireless 59
- bonding (See Bluetooth wireless)

- browser 88
 - disconnect 88

C

- calculator 86
- calendar 85, 86

O

- object exchange 60
- open
 - program 21
- open program 21
- optional accessory 22
- optional feature 22
- over the air (OTA) 63
- owner information 82, 83

P

- pairing (See Bluetooth wireless)
- PC remote 61
- personalise 81
- phone 35
- phone number 27
- photo 72, 87
- picture 87
- picture ID 44, 80
- power key 2, 3, 25

- call

- answer 26, 40
 - end 26
 - forwarding 78
 - make 25
- call timers 83
- caller ID 44, 80
- camera 72, 74
- camera key 2, 3
- cancel message 50
- car kit 84
- center key 3
- centre key 2, 3
- certificate management 87
- codes 35
- conference calls 46
- contacts 45, 79
- copy files 60

- priority 50
- profile 37
- program
 - open 21

R

- received calls 42
- recent calls 42
- redial 43
- reminders 82
- remote control 61
- remove program 41
- reply 54
- return a call 43
- ring style indicator 31
- ring style, setting 37
- ring tone 88
- ringer ID 44, 79
- ringer volume 81
- roam indicator 31

D

- date, 38
- delete program 41
- dial a phone number 25
- dialled calls 42
- display 29, 40
- download e-mail messages 55
- download message objects 54

E

- e-mail 48, 52, 53
 - attachment 53
 - signature 53
- emergency number 44
- end a call 26
- end key 2, 3, 26
- enter
 - numbers 32
 - text 32, 33

S

- security
 - lock 35
- send and receive messages 48
- send key 2, 3, 25
- shortcuts 45
- side scroll keys 2
- side select key 2
- signal strength indicator 31
- signature 53
- SIM card 22
- soft keys 2, 3, 29
- sounds 82, 88
- speakerphone 84
- speed dial 45
- Start menu 21
- store your number 27
- symbol entry mode 33
- sync (cable) 65

F

- filter 43
- forward 54
- forward calls 78

G

- games 88

H

- handsfree 84
- handsfree speaker 34
- headset 84
- headset jack 3
- home screen 29, 39
- hyperlink
 - phone number 79

I

- IM 57
- Incoming Call message 44
- instant messaging 57

- synch (Bluetooth) 66
- synchronise 63
- synchronising with
 - computer 64

T

- task manager 41
- telephone number. See phone number
- text 32
- text entry 32
- text message 52, 53, 54
- third party applications 40
- three way calling 46
- time, setting 38
- timers 43, 83
- TTY calls 78
- turn on/off 25

- international access code 44
- ISP 52

L

- language 81
- linking (See Bluetooth wireless)

- lock

- phone 35
- Low Battery message 31
- lowercase 33

M

- make a call 25
- make call 79
- master clear 83
- master reset 82
- menu icons 29
- menu indicator 29
- menu key 2, 3
- menu shortcuts 45
- message 52, 53, 54

index **99**

100 index

index **101**

W

wallpaper 39

web 88

 phone number 79

web browser 88

 disconnect 88

web page 88

WHO information 92

Y

your phone number 27

U.S. patent Re. 34,976

6803575F03